

**THESIS REPORT ON**  
**“CORPORATE OFFICE“**  
**NOIDA, UTTAR PRADESH**

**A THESIS SUBMITTED IN PARTIAL FULFILLMENT OF THE  
REQUIREMENT FOR THE DEGREE OF:**

**BACHELOR OF INTERIOR DESIGN**  
**BY**

**(NARAYAN AGARWAL)**  
**(1180107022)**

**THESIS GUIDE**  
**(PROF.MOHIT KUMAR AGARWAL , AR.SHALINI DIWAKER,)**

**SESSION**  
**2021-22**

**TO THE**  
**SCHOOL OF ARCHITECTURE AND PLANNING BABU BANARASI**  
**DAS UNIVERSITY**  
**LUCKNOW.**

**SCHOOL OF ARCHITECTURE AND PLANNING  
BABU BANARASI DAS UNIVERSITY, LUCKNOW (U.P.).**

**CERTIFICATE**

I hereby recommend that the thesis entitled “Corporate Office, Delhi” under the supervision, is the bonafide work of the students and can be accepted as partial fulfillment of the requirement for the degree of Bachelor’s degree in interior design, school of Architecture and Planning, BBDU, Lucknow.

---

Prof. Mohit Kumar  
Agarwal  
Dean of Department

---

Prof. Sangeeta  
Sharma  
Head of Department

Recommendation      Accepted

Not Accepted

---

External Examiner

---

External Examiner

# **BABU BANARASI DAS UNIVERSITY, LUCKNOW (U.P.).**

## **Certificate of thesis submission for evaluation**

•Name : NARAYAN AGARWAL

•Roll No. : 1180107022

•Thesis Title :HOTEL

•Degree for which the thesis is submitted : BACHELOR OF INTERIOR DESIGN

•Faculty of University to which the thesis is submitted: Yes / No

•Thesis preparation guide was referred to for preparing the thesis. Yes / No

•Specification regarding thesis format have been closely followed. Yes / No

•The content of the thesis have been organized based on the guidelines. Yes / No

•The thesis has been prepared without resorting to plagiarism Yes / No

•All the sources used have been cited appropriately Yes / No

•The thesis has not been submitted elsewhere for a degree. Yes / No

•Submitted 3 hard bound copied plus one CD Yes / No

.....  
PROF. MOHIT AGARWAL  
AR. SHALINI DIWAKER  
THESIS GUIDE  
SCHOOL OF ARCHITECTURE

.....  
(Signature of the Candidate)  
Name NARAYAN AGARWAL  
Roll No 1180107022

# ACKNOWLEDGEMENT

Time demands that I express my gratitude to those who have been a part of my stay in B.B.D.U. It's been great, all these years, but life moves on and so do we. I express my deepest gratitude to my thesis guides **AR.**

**SHALINI DIWAKER** and **PROF. MOHIT AGARWAL** for their valuable passionate guidance, critical discussions, suggestions and continuous support all through my B.I.D thesis.

I express my gratitude to **DEAN (PROF. MOHIT AGARWAL)** and **H.O.D. (PROF. SANGEETA SHARMA)**, Department of Architecture, B.B.D.U., Lucknow, for being there to solve our problems. I am grateful to thesis coordinators **AR. SAURABH SAXENA** and **AR. ABHINAV KHARE** for providing their useful comments at the various stage submissions.

My all teachers, your support, encouragement and guidance have given us the strength to embark on this rigorous journey. My parents, saying thanks is nothing, just accept this as a tribute to what you have made me. It would have not been possible without my FRIEND- **FAIZA AFROZ** and **LAMA TALIB**. Though words hardly express the true emotions, still I would like to thank all my near and dear ones who helped and guided me I completing my Thesis.



## TABLE OF CONTENT

S.NO.	TITLE	PAGE NO.
1	SYNOPSIS	1-2
2	SITE ANALYSIS	3-5
3	LITERATURE STUDY 1	6-11
4	LITERATURE STUDY 2	12-17
5	CASE STUDY 1	18-24
6	CASE STUDY 2	25-29
7	CONCEPT	30-36
8	DRAWINGS	37-49



## INTRODUCTION

- AN OFFICE IS A SPACE WHEN AN ORGANIZATION'S EMPLOYEES PERFORM ADMINISTRATIVE WORK IN ORDER TO SUPPORT AND REALIZE OBJECTS AND GOALS OF THE ORGANIZATION.
- WORK SPACES IN AN OFFICE ARE TYPICALLY USED FOR CONVENTIONAL OFFICE ACTIVITIES SUCH AS READING, WRITING AND COMPUTER WORK.
- IN OFFICES ONE CAN FIND CUBICLES, MEETING ROOMS, LOUNGES, AND SPACES FOR SUPPORT ACTIVITIES, SUCH AS PHOTOCOPYING AND FILING. MOST OFFICES NOW ALSO HAVE A KITCHEN AREA.

## AIM OF THE PROJECT

- Adopt best practices of Project and Operations & Maintenance Management leading to System Efficiency, Reliability and Commercial Viability.
- Create a work environment which motivates & enhances Employee Performance, Value Systems and Reward Contribution.
- Develop and train employees towards upgrading their skills at work, enrich work content to made it more substantive and responsive to Company Goals.
- Imbibe transparency and accountability in all operational areas, be it Procurement, Construction, Operations and Maintenance.

## SITE PLAN DETAILS



### UTTAR PRADESH

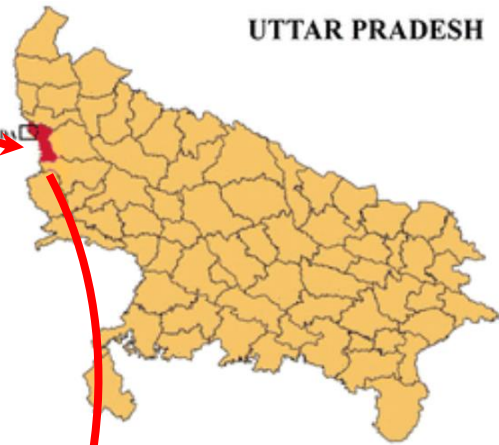

## CONNECTIVITY

- **THE ICONIC CORENTHUM** IS A PART OF THE CORENTHUM ARENA AND LOCATED ON PLOT NO. A-41, SECTOR-62, NOIDA.
  - IT IS WITHIN THE 20,000 SQMTS LAND AREA OF 'THE CORENTHUM' WHICH HOUSES BUSINESS ADDRESSES FOR YAMAHA, OTIS, TATA'S, AXIS BANK, SBI, BHARAT FORGE, VOLVO, BHASKAR PRAKSHAN, WALLEN SHIP MANAGEMENT, ZOMATO AND MANY MORE.
  - THE ICONIC CORENTHUM IS ABUTTED BY A 30M ARTERIAL ROAD, SITUATED RIGHT BY NH-24. SECTOR – 62 IS AN URBAN WORK DESTINATION FOR MULTINATIONAL IT AND BPO ORGANIZATIONS. IT ALREADY HOUSES NAMES SUCH AS – IBM, XEROX, BARCLAYS, SAMSUNG, HCL, DLF, JAYPEE, AIRTEL TO NAME A FEW MNC/CORPORATES.
- **CLOSE TO NH 24**
  - **FORTIS HOSPITAL : 750 MTS**
  - **CONNAUGHT PLACE : 25 MINS**
  - **AKSHARDHAM :15 MINS**
  - **NOIDA CITY CENTER METRO :5 MINS**
  - **SECTOR 18 NOIDA : 18 MINS**
  - **IGI AIRPORT : 45 MINS**
  - **NEHRU PLACE : 25 MINS**

## SITE LOCATION

- **Location:** Tower B, First Floor 51/2 The Corenthum, Sector 62, Noida, Uttar Pradesh 201301
- **Site Area:** 10485 Sq. Ft. **Total Area:** 17600 Sq. Ft.
- **Site Shape:** Rectangular
- **Latitude & Longitude:** 28°37'35"n 77°22'23"e
- **Site Features:** Close To Nh 24, 5 Min. Distance From Noida City Center Metro.

## PROPOSED BUILDING







## INTRODUCTION

An office is a space when an organization's employees perform administrative work in order to support and realize objects and goals of the organization.

Office type: **Advertisement Agency Office**

## ABOUT THE CITY

- Noida (New Okhla Industrial Development Authority) is a planned city located in Gautam buddha Nagar district of the Indian state of Uttar Pradesh.
- It is spread over an area of 203 sq. Kilometers, and has a population of around 0.64 million.
- Noida has become a hub for software and mobile app development companies like Microsoft.
- Home to India's largest unicorn startup Paytm.

## SITE LOCATION

- **Location:** Tower B, First Floor 51/2 The Corenthum, Sector 62, Noida, Uttar Pradesh 201301
- **Site Area:** 10485 Sq. Ft. **Total Area:** 17600 Sq. Ft.
- **Site Shape:** Rectangular
- **Latitude & Longitude:** 28°37'35"n 77°22'23"e
- **Site Features:** Close To Nh 24, 5 Min. Distance From Noida City Center Metro.

## SITE PLAN DETAILS



### UTTAR PRADESH

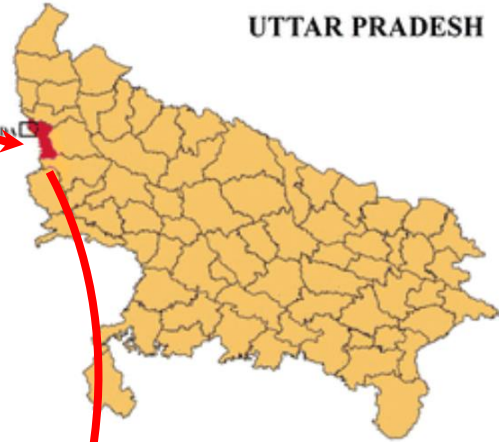

## SITE PLAN

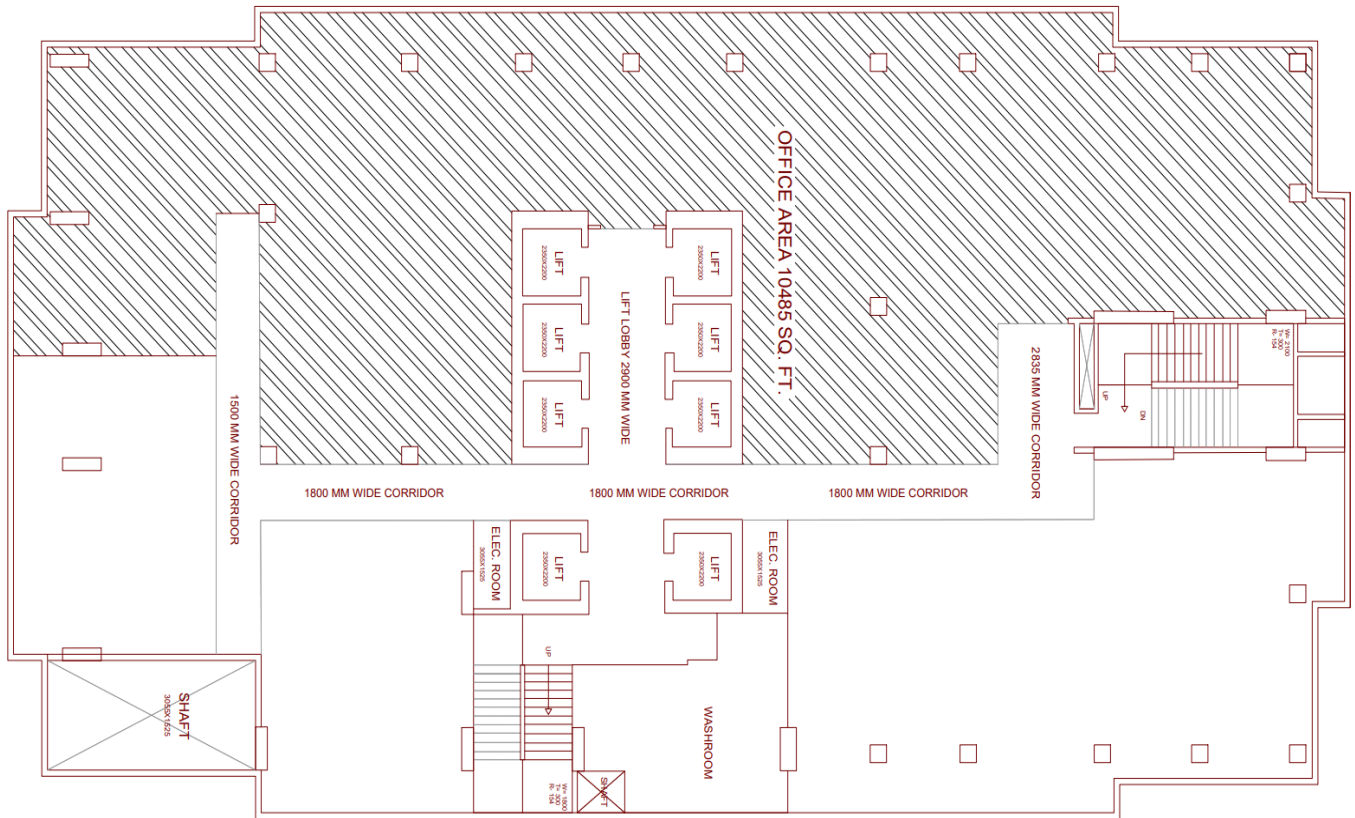

## LANDMARKS



AKSHARDHAM TEMPLE



FORTIS HOSPITAL



NOIDA SECTOR 62 GOL CHAKKAR

## ACCESSIBILITY TO THE SITE

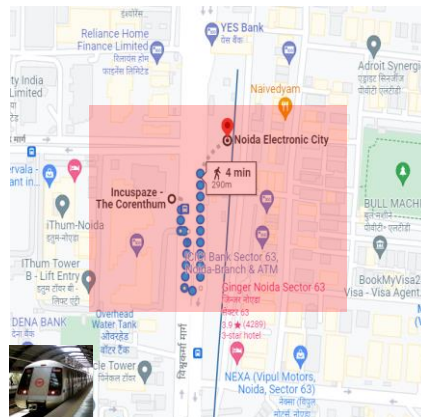

Noida Electronic City Metro Station 290 KM

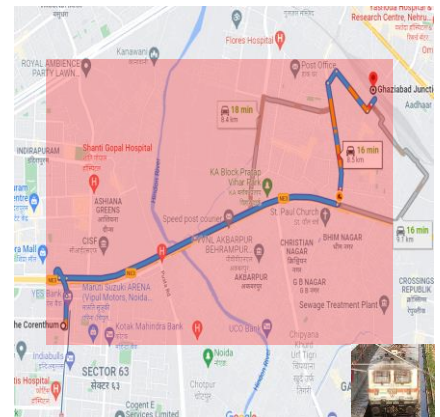

Ghaziabad Railway Station 8.5KM

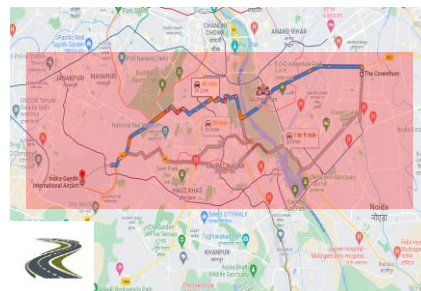

NH24 14.5KM

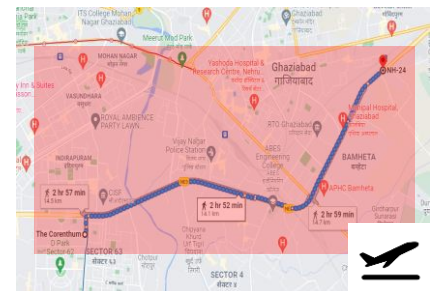

Indira Gandhi International Airport 30.2KM

## CLIMATIC CONDITION

- Noida has hot and moist climate for the vast majority of the year. The climate stays hot during summers, I.E. From march to June, and temperature ranges from most extreme of 48°C to least of 28°C.
- Rainstorm season occurs during mid-June to mid- September with a rainfall of 93.2 cm (36.7 inches), but sometimes heavy rainfall causes flood.
- Temperatures tumble down to as low as 3°C at the crest of winters. Additionally, it has haze and cloud in winters.

## SUN & WIND PATH DIAGRAM

**Wind Speed:** The Average Wind Speed In Noida Is 2.5 M/S With The Maximum Wind Speed Of Around 8 M/S.

**Temperature:** The Average Ambient Temperature Remains 24.3°C, Varies From 5°C To 42.4°C.

**Humidity:** The Average Relative Humidity Remains Around 66.4%, Varies From 11% To 99.8%.

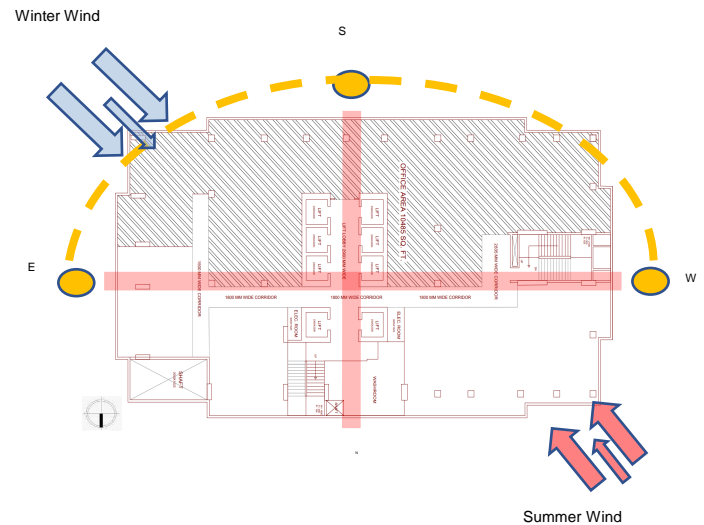

Temperature

	January	February	March	April	May	June	July	August	September	October	November	December
Avg. Temperature °C (°F)	13.5 °C (56.4 °F)	16.9 °C (62.4 °F)	22.5 °C (72.6 °F)	29.1 °C (84.5 °F)	32.7 °C (91.3 °F)	32.9 °C (91.3 °F)	29.9 °C (85.8 °F)	26.7 °C (80.1 °F)	27.7 °C (81.9 °F)	25.2 °C (77.3 °F)	20.4 °C (68.7 °F)	15.3 °C (59.6 °F)
Min. Temperature °C (°F)	7.7 °C (45.9 °F)	10.6 °C (51.1 °F)	15.2 °C (59.3 °F)	21 °C (69.8 °F)	25.3 °C (77.5 °F)	27.6 °C (81.5 °F)	26.6 °C (80.1 °F)	25.8 °C (78.5 °F)	23.9 °C (75.1 °F)	18.9 °C (66.1 °F)	14 °C (57.2 °F)	9.2 °C (48.5 °F)
Max. Temperature °C (°F)	20.1 °C (68.1 °F)	23.6 °C (74.4 °F)	29.8 °C (85.7 °F)	36.7 °C (98.1 °F)	38.6 °C (101.5 °F)	38.2 °C (100.7 °F)	33.6 °C (92.5 °F)	32.1 °C (90.1 °F)	31.6 °C (88.9 °F)	27.3 °C (81.2 °F)	23.2 °C (73.8 °F)	18.9 °C (66.1 °F)
Precipitation / Rainfall mm (in)	23 (0.9)	33 (1.3)	20 (0.8)	14 (0.6)	20 (0.8)	74 (2.9)	268 (10.5)	183 (7.2)	99 (3.9)	13 (0.5)	5 (0.2)	8 (0.3)
Humidity (%)	68%	62%	48%	29%	32%	47%	72%	78%	73%	58%	55%	62%
Rainy days (d)	2	3	3	3	4	7	15	16	8	2	1	1
avg. Sun hours (hours)	9.2	9.4	10.8	11.6	12.1	11.8	9.5	9.5	9.3	10.1	9.6	8.9

Wind Direction

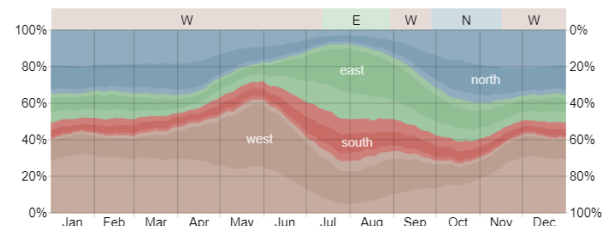

Average High & Low Temperature

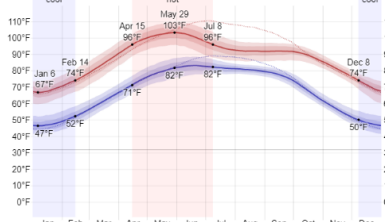

Humidity Comfort Level

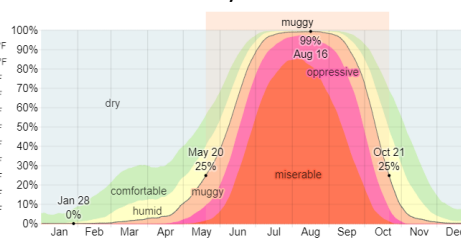

Average Wind Speed

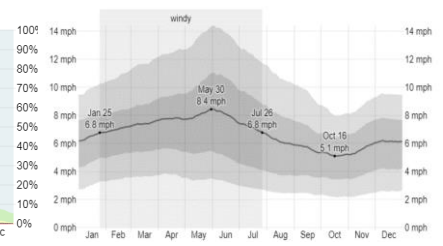

Average Monthly Rainfall

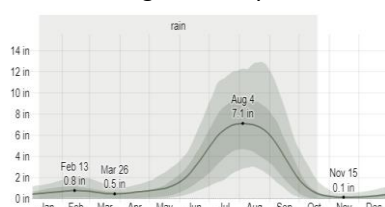

Cloud Cover Categories

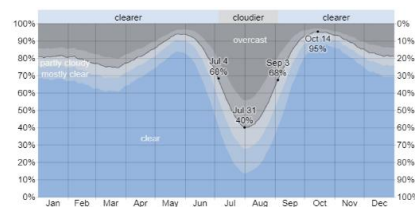



**01**

**LITERATURE STUDY**



## XIAOZHU

Xianzhi is a consumer-to-consumer short-term home and apartment rental platform based in Beijing, China.. Headquartered in Beijing, xiaozhu commissioned people's architecture office and people's industrial design office to design sliced house, Their latest office space located in the city's hi-tech center.

The startup is China's rival to Airbnb and part of the country's new 'shared economy'.

**Project Name:** Sliced House (House Parts Office)

**Architects:** People's Architecture Office

**Area:** 350 M<sup>2</sup>

**Year:** 2016

**Client:** Xiaozhu.Com

**Design Team:** Jiang Hao, Zhang Zhen, Amy Song, Ren Depei, Chen Yihuai

**Country:** China

## ABOUT THE CITY

Beijing, capital of China.

It is the world's most populous national capital city, with over 21 million residents within an administrative area of 16,410.5 km<sup>2</sup> (6336 sq. Mi.).

It is home to the headquarters of most of China's largest state-owned companies.

## SITE PLAN DETAILS



## SITE LOCATION

- **Location:** Taizhou Hutong , Yard No. 37, Xi Cheng District, Beijing 100051
- **Site Area:** 350 Sq. Mt.
- **Site Shape:** Rectangular
- **Latitude & Longitude:** 39°53'46"n 116°23'23"e

## CLIMATIC CONDITION

- **Wind speed:** the average wind speed in Beijing is around **2.0 m/s in august/September**. Significant diurnal variations would be seen in wind speed.
- **Temperature:** the average annual temperature is **12.7 °c | 54.9 °f**.
- **Rainfall:** the annual rainfall is **566 mm | 22.3 inch**

## LANDMARK



Temple Of Heaven



Beijing Dahlan



Zhongyang



Beijing Normal University Affiliated Middle School

## ACCESSIBILITY TO THE SITE



ZHONGWAI YUNJIZHUANGXIANG TRANSPORT LT. **2.7KM**



TAXI STAND IN **3.3KM**



## CONCEPT

- Sliced house is conceived as a house that has been divided and its parts dispersed throughout. Shared interior finishes between split spaces make apparent that adjacent portions refer to a single room. These sliced samples of domesticity include kitchen, living room, and bedroom and double as ad hoc meeting areas.
- Unpredictable rapid growth requires a highly **flexible work environment** which is there in office
- The design features spaces and **furniture** that easily *combine* and *separate*, mobile meeting rooms, and power outlets that swing to desired locations. Like Xianzhi's online business,
- The office interior consists of a collage of various *domestic spaces*.
- The design inserts the **casual comfort** of home life into the workplace, reflecting the company's **open spirit**.
- **Flexibility** and **diversity** of workspaces and furniture facilitate *spontaneous* interactions in order to encourage the exchange of ideas.

## PLAN LAYOUT



OPTION A

OPTION B

### HEADS:

- OPEN OFFICE
- MEETING ROOM
- CONFERENCE ROOM
- LOUNGE
- RECEPTION
- BAR
- MOBILE MEETING ROOM

DIAGRAM

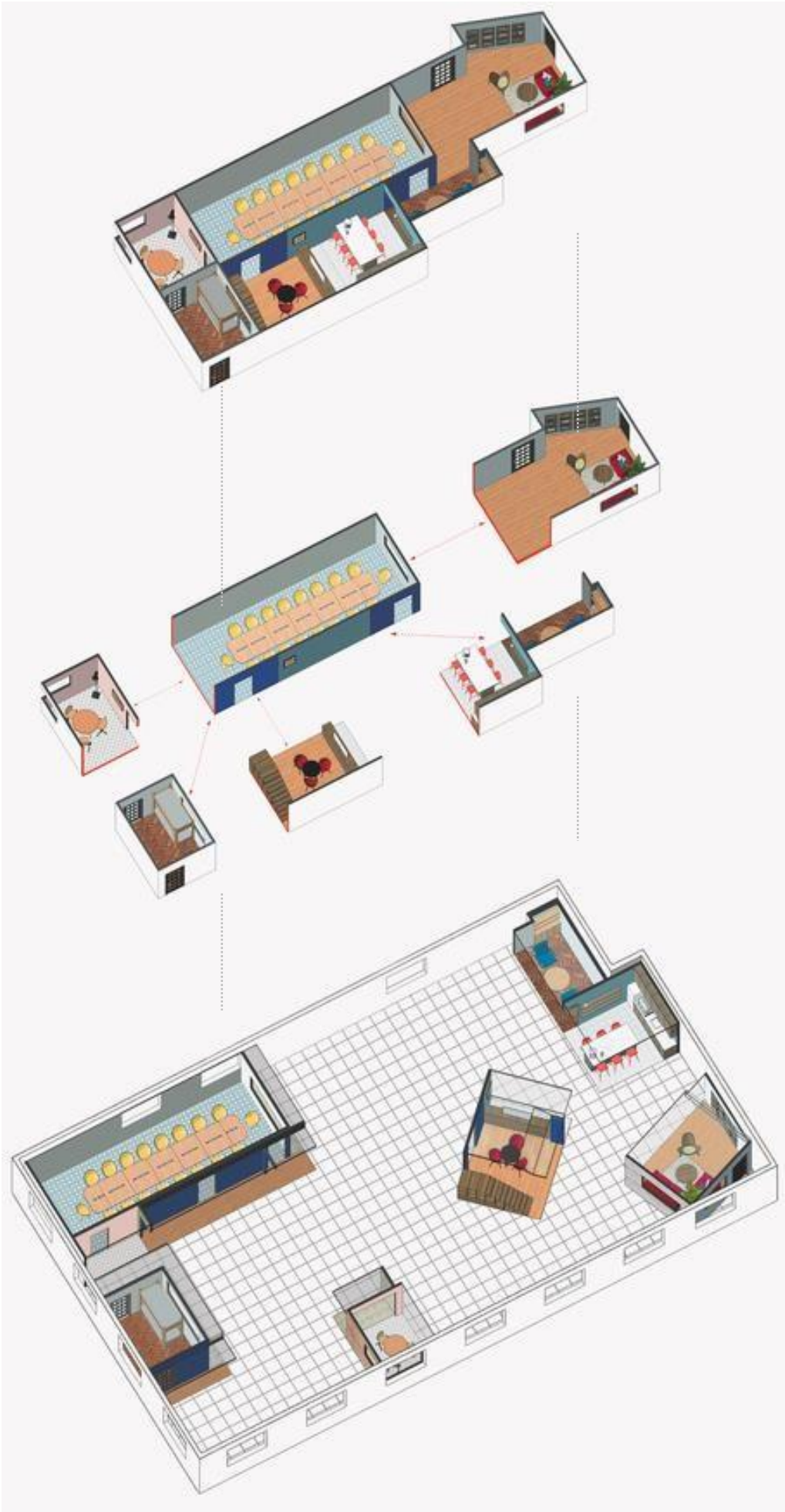



## INTERIOR VIEWS

### MOBILE MEETING ROOM



It Features Converted Tricycles – Workspaces And Informal Meeting Areas On Wheels - That Are Inspired By Their Tricycle House



Long Span Cantilevering Tables Supported By Only Four Legs Create Undisrupted Space Underneath To Provide Seating Flexibility. Not Only Does This Allow For Space To Expand, But Passersby Can Sit Down And Squeeze In For Spontaneous Conversation.

### CONFERENCE ROOM



A Long Conference Table Can Be Separated Into Three Smaller Tables, Allowing The Conference Room Itself To Be Divided Into Three Smaller Rooms When Necessary.



INTERIOR VIEWS



SUN & WIND PATH  
DIAGRAM

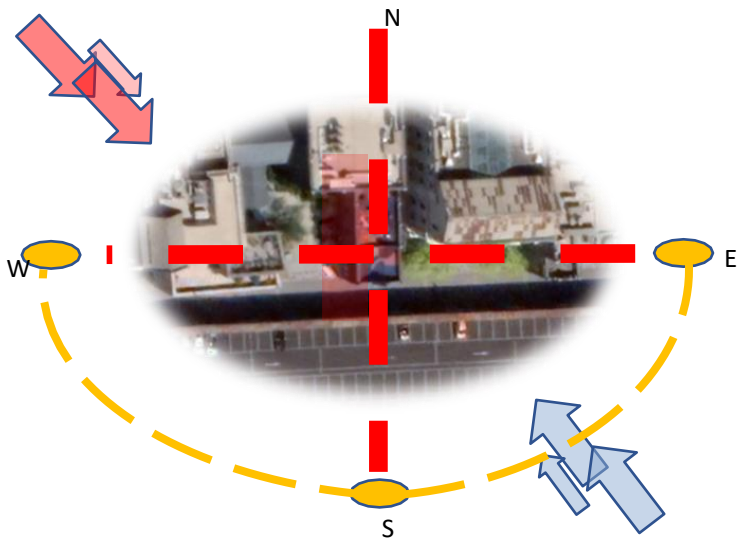

**02**

**LITERATURE STUDY**



## PERSIAN GARDEN STUDIO

The interior design office "Iranian garden" in 2001. This young office has presented a variety of interior design projects in the residential, office, commercial and service areas, or even the design of exhibition stands and urban spaces.

**Project Name:** Private Office Headquarters / Persian Garden Studio

**Architects:** Persian Garden Studio

**Area:** 1000 M<sup>2</sup>

**Year:** 2019

**Design Team:** Pangea Parham, Anousheh Ahmadi, Mina Nabawi

**City:** Tehran

**Country:** Iran

### ABOUT THE CITY

Tehran, capital of Iran and Tehran province. Tehran is the most populous city in Iran with around 8.7 million people in the city and 15 million in the larger metropolitan area of greater Tehran. It is epitomized by the Milad tower.

### SITE LOCATION

**LOCATION:** QCCW+FHP DISTRICT 3, TEHRAN, TEHRAN PROVINCE, IRAN

**SITE AREA:** 1000 SQ. MT.

**SITE SHAPE:** RECTANGULAR

**LATITUDE & LONGITUDE:** 35°46'16"N 51°26'47"E

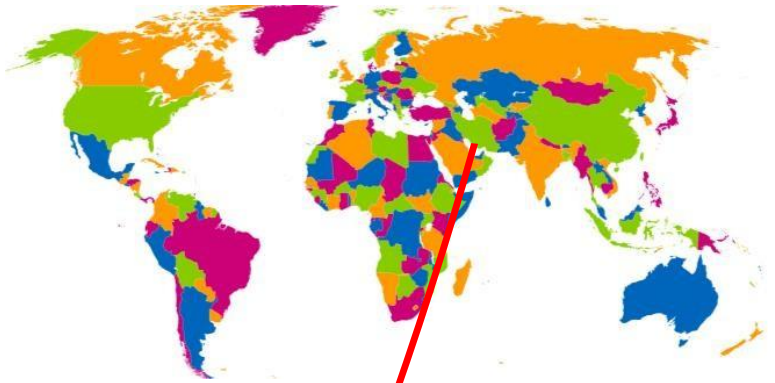

Nikan Elementary And Middle School نیکان

## CLIMATIC CONDITION

**Wind speed:** the average wind speed in Tehran is around **5.4 miles per hour**. **From February to September**. Significant diurnal variations would be seen in wind speed.

**Temperature:** the average annual temperature varies from **34°F to 97°F** and is rarely below **26°F** or above **102°F**.

**Rainfall:** the average annual rainfall is not higher than **230 millimeters (9 inch)**.

## ACCESSIBILITY TO THE SITE

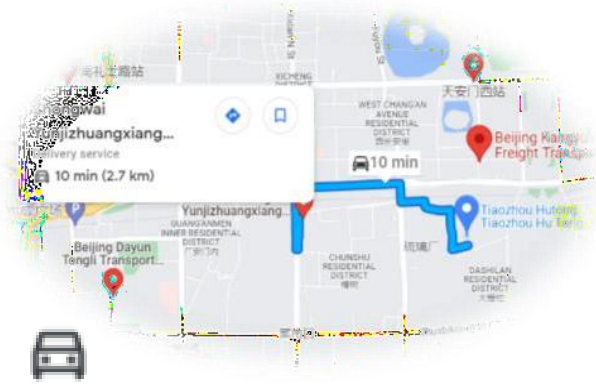

ZHONGWAI YUNJIZHUANGXIANG TRANSPORT LT. **2.7KM**



TAXI STAND IN **3.3KM**

## LANDMARK



Temple Of Heaven



Beijing Dahlan



Zhongyang



Beijing Normal University Affiliated Middle School



## CONCEPT

- The concept of the design is based on industrial theme.
- The circular volumes are used in the interiors, inspired by the shape of the building and the idea of bringing together staff.
- The client requested for an open plan office with free seating concept and was keen on promoting the manufacturing industrial nature of their work in the new office.
- Since the space was previously used as a showroom and had many additional elements to its existing architecture the first design step was to remove all additional partitions, wood and plaster work on ceiling, walls and columns. This allowed us to reveal the existing concrete ceiling and its mechanical and HVAC elements. The ceiling was then cleaned painted and remained exposed in the final design.

## PLAN LAYOUT

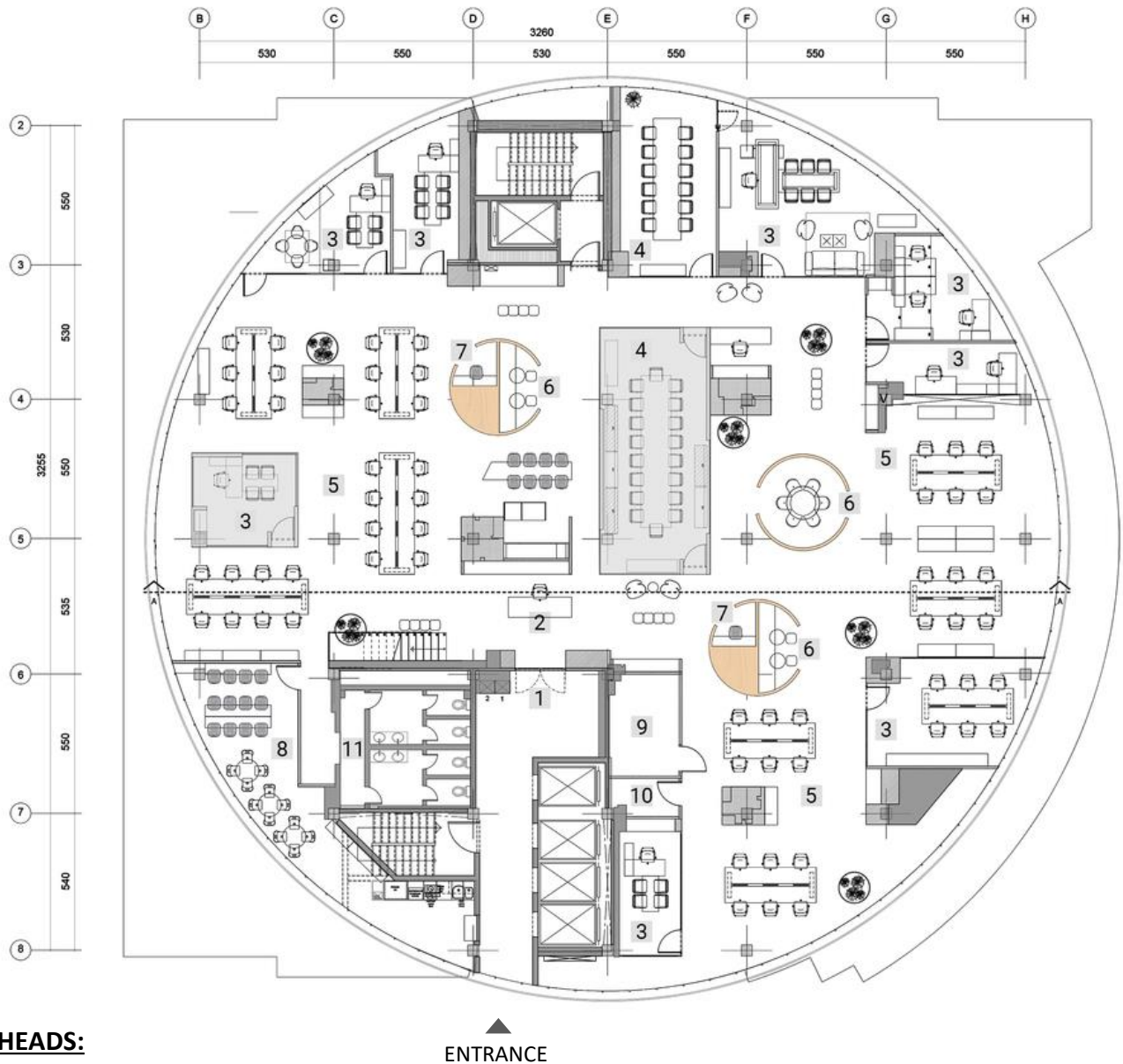

### HEADS:

- |                   |                |
|-------------------|----------------|
| • ENTRANCE        | • PHONE BOOTH  |
| • RECEPTION       | • CANTEEN AREA |
| • MANAGER OFFICE  | • SERVER ROOM  |
| • CONFERENCE ROOM | • STORAGE      |
| • OPEN OFFICE     | • WASHROOM     |
| • MEETING         |                |

# **DIAGRAM**

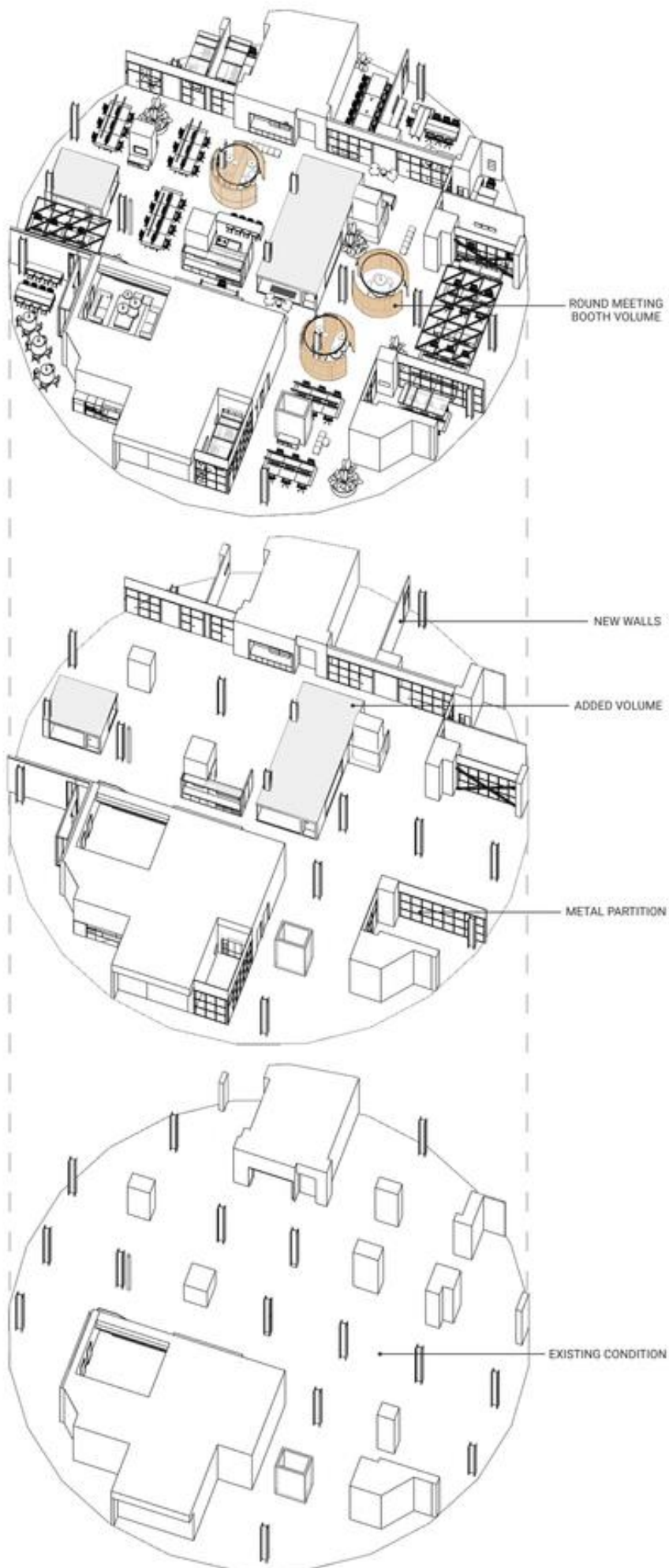

## SECTION



**SUN & WIND PATH  
DIAGRAM**

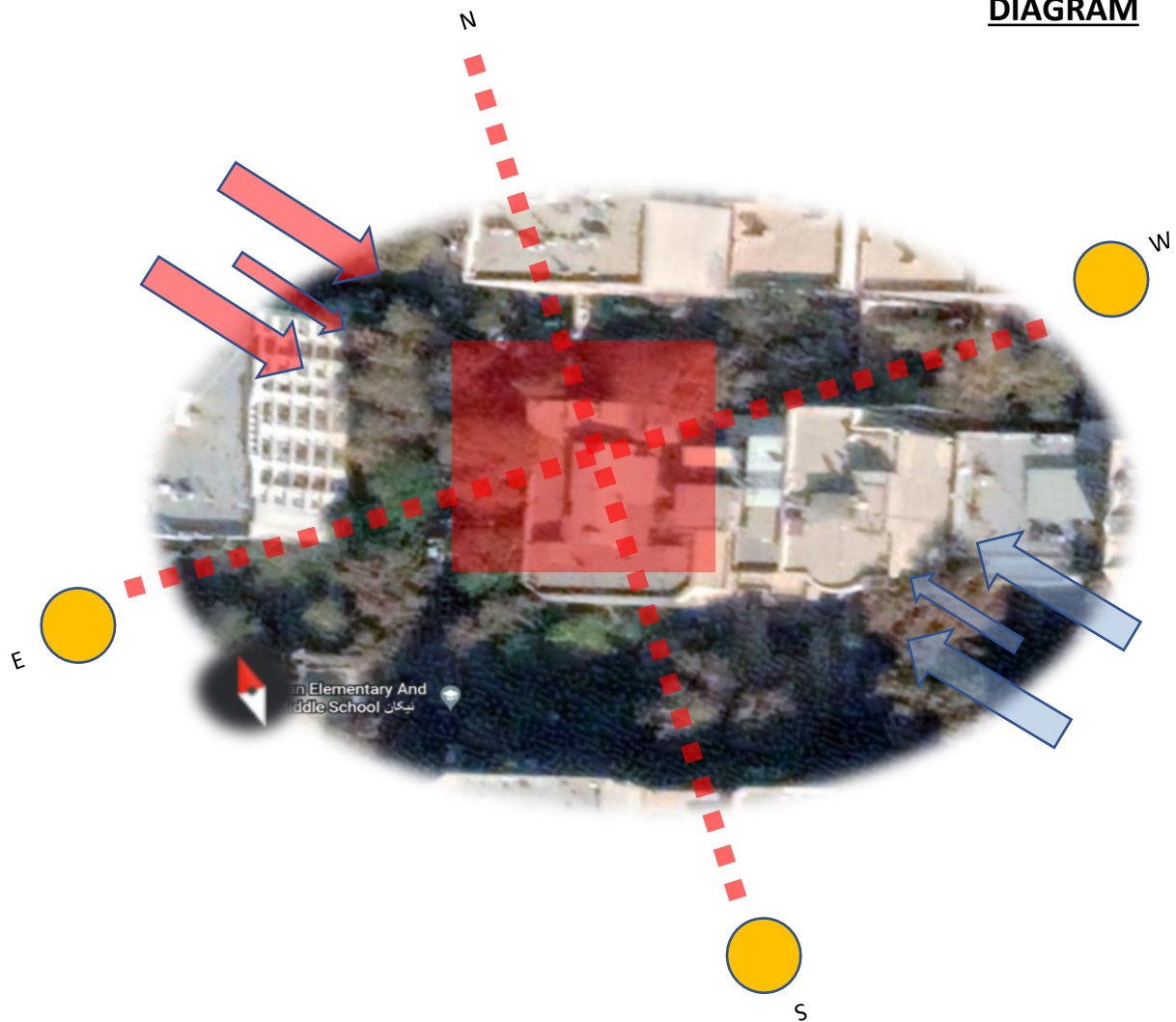



## INTERIOR VIEWS



The client requested for an open plan office with free seating concept and was keen on promoting the manufacturing industrial nature of their work in the new office.



The circular volumes, inspired by the shape of the building and the idea of bringing together staff, were then added to function as phone booths and meeting areas. These volumes were built with a metal structure and then covered with stripes of local oak wood. Using a material such as natural wood in contrast with metal in the space balanced the warm and cool tones and textures.

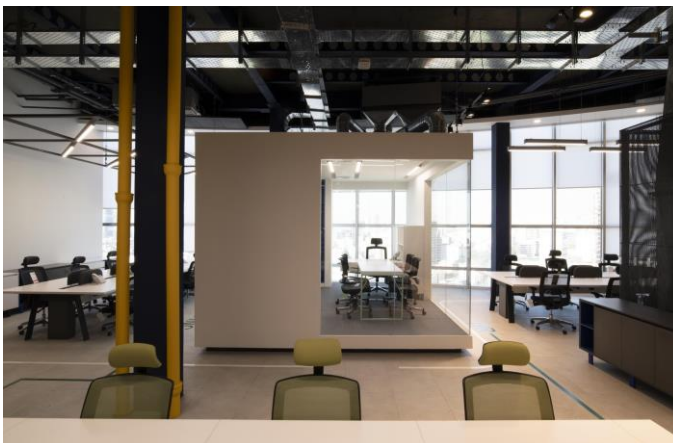
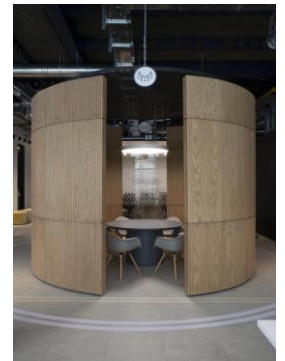

Two floating islands were then added within the open space to house the main conference room and a manager's office. These pure cubic forms were strategically located in order to create an enjoyable office flow and interesting pathways through the office. These pathways were then made graphically bolder with floor signage and walk & talk paths were assigned to promote physical activity in the office.

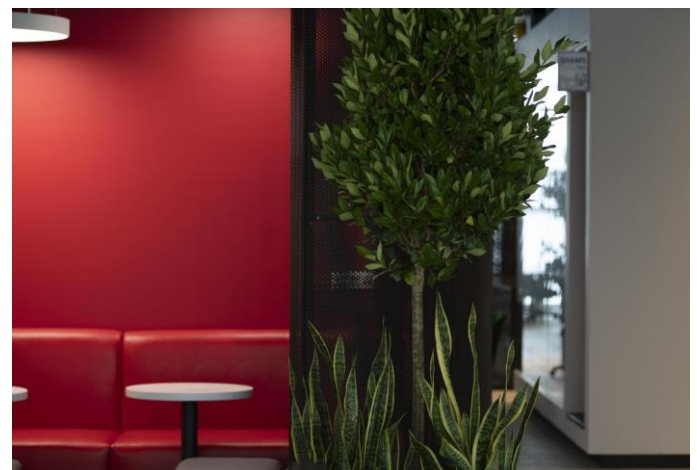

Finally the heart of the office, the bar area was added in the middle of the space to create a social hub, gathering space and informal meeting area for the staff to enjoy. Greenery and plants were always part of the initial design concept and was added using large portable metal planters.

**01**

**CASE STUDY**



## TRULYMADLY MARKETING PRIVATE LIMITED

TRULYMADLY is a **tinder-like dating app** that has adapted to India's culture to offer different ways to connect, primarily via a trusted source system that helps give peace of mind when chatting. Tinder puts a lot of focus on location, but TRULYMADLY instead looks to compatibility quizzes and scoring.

**Architects:** Studio Wood

**Area:** 465 M<sup>2</sup>

**Employees:** 60+

**Year:** 2015

**Design Team:** Navya Aggarwal, Sahej Bhatia, Vrinda Mathur

**Primary Materials:** Chipboard, Wood, Metal, Epoxy

**City:** Delhi

**Country:** India

### ABOUT THE CITY

- Delhi shares borders with the state of Uttar Pradesh in the east and with the state of Haryana in the remaining directions.
- It covers an area of 1,484 sq. Km.
- It has an estimated population of over 28 million.
- It the largest metropolitan area in India and the second-largest in the world.

### SITE LOCATION

**LOCATION:** 2-A/3, KUNDAN MANSION, ASAF ALI ROAD, NEW DELHI, INDIA

**SITE AREA:** 450 SQ. MT.

**SITE SHAPE:** RECTANGULAR

**LATITUDE & LONGITUDE:** 28°38'28"N  
77°14'01"E

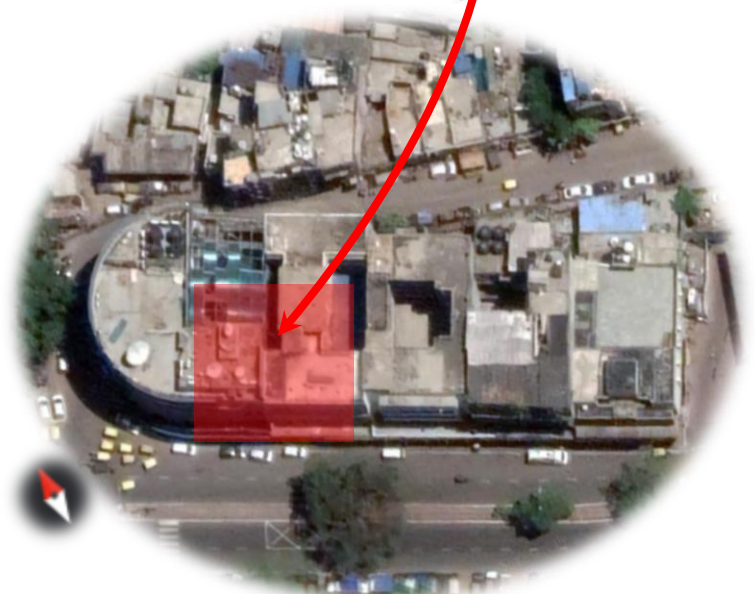



## CLIMATIC CONDITION

**Wind speed:** the average wind speed in Delhi is 2.5 m/s with the maximum wind speed of around 8 m/s.

**Temperature:** the average ambient temperature remains 24.6 °c (76.3 °f).

**Rainfall:** the annual rainfall is 700 mm (27.6 inch).

## ACCESSIBILITY TO THE SITE

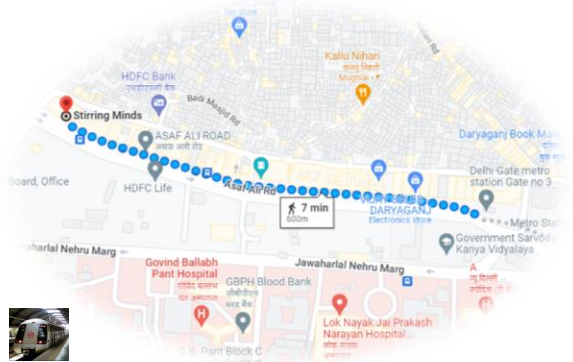

DELHI GATE METRO STATION **600M**

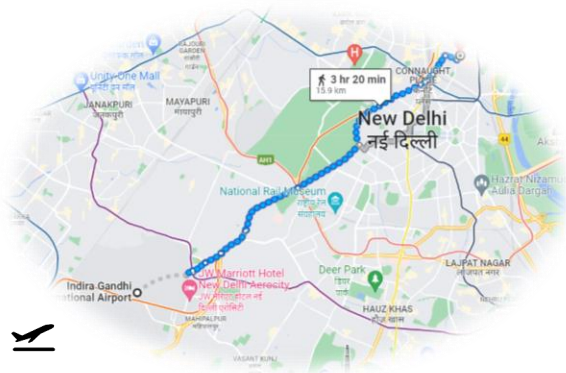

I.G.I. AIRPORT **15.9 KM**

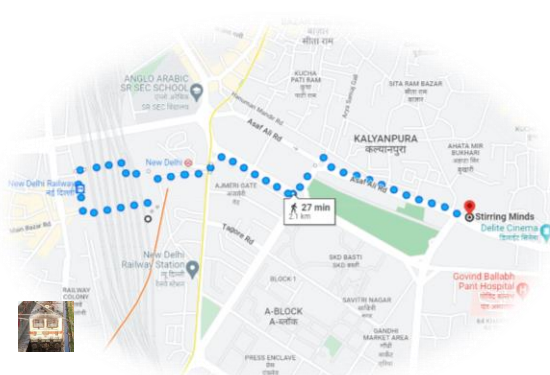

NDLS **2.1 KM**

## LANDMARK



RAMLEELA GROUND



MAHILLA HAAT



DELITE CINEMA

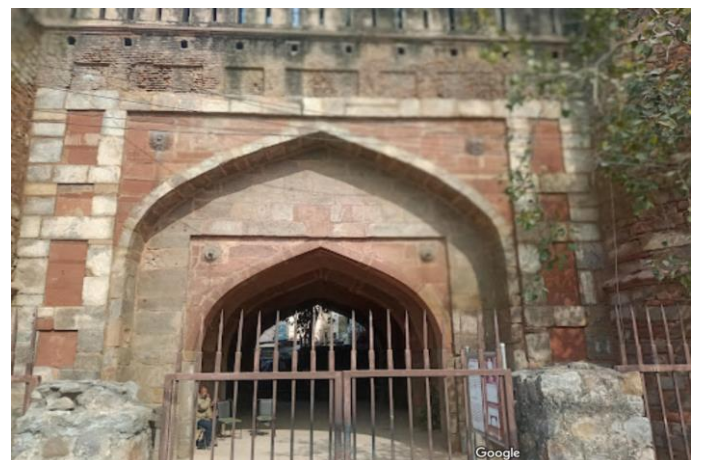

DELHI GATE

## CONCEPT

The 5000 square foot space was segmented into three zones namely 'unravel' at the working space, 'unsingle' at the conference area and 'unwind' at the basement cum cafeteria. The concept of 'finding love anywhere' emerged as we started working on the layout keeping in mind an outdoorsy ambiance. The aim was to create a non-office, office space

## PLAN LAYOUT

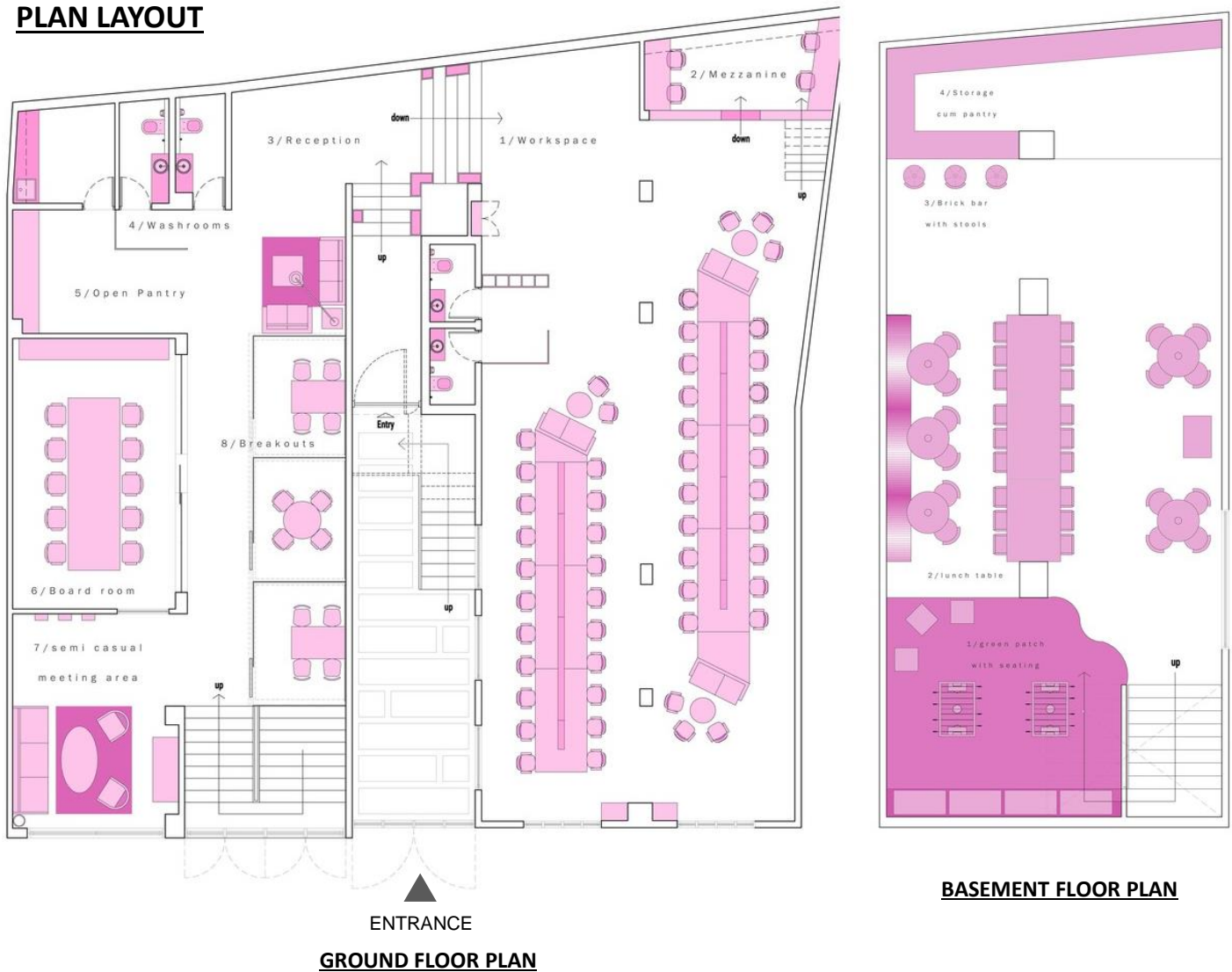

### HEADS:

1. WORKSPACE
2. MEZZANINE
3. RECEPTION
4. WASHROOMS
5. OPEN PANTRY
6. BOARD ROOM
7. SEMI CASUAL MEETING ROOM
8. BREAKOUTS

### HEADS:

1. GREEN PATCH WITH SEATING
2. LUNCH TABLE
3. BRICK BAR WITH STOOLS
4. STORAGE CUM PANTRY



## INTERIOR VIEWS

### ENTRANCE

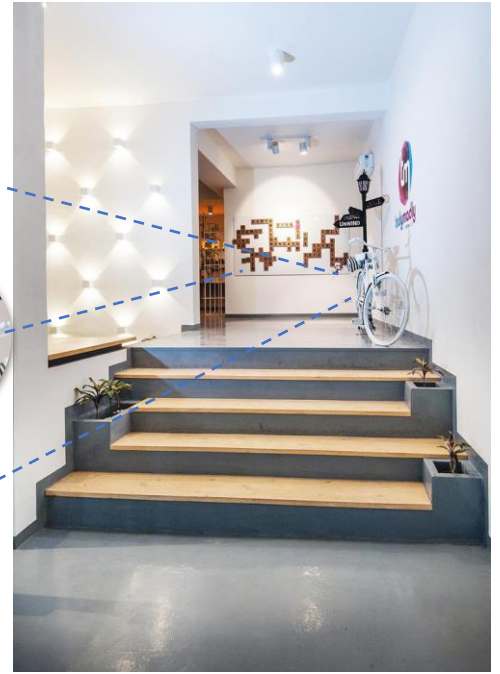

At the entrance, one gets the first glimpse of a street-like view complete with greens, signages' and a strategically parked bicycle.

### BREAKOUT ROOM

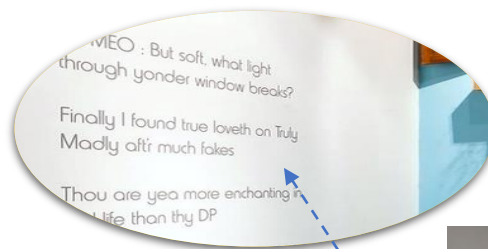

Alongside the floating box is a gallery lined by conference or breakout rooms. These rooms' glass walls give a sense of seamlessness, which is also reflected in the flooring pattern designed using twin colored carpet tiles.

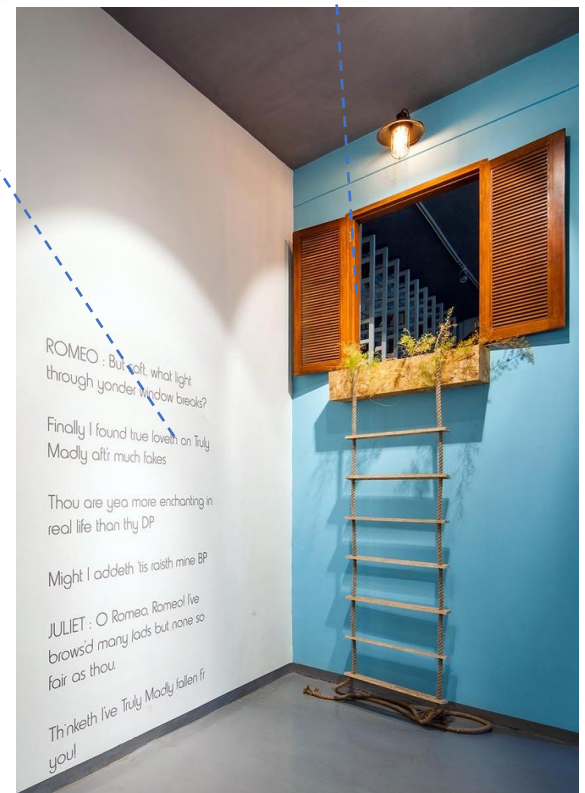

On turning right, one finds himself facing a double height room with a metaphorical window & words in Shakespearean English adorned on the wall.



## INTERIOR VIEWS

### MEZZANINE AND STEP DOWN SPACE

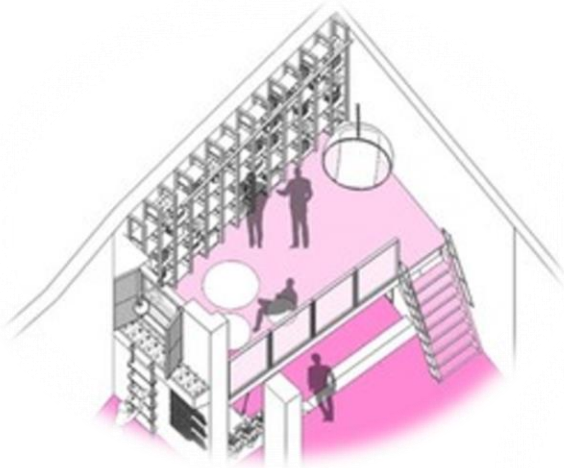

15x7 feet. Mezzanine which is also dug 2 feet into the earth as a step down space which seats the accounts department and HR team of 4 persons.

This corner is designed keeping in mind the potential of loftiness within the space.

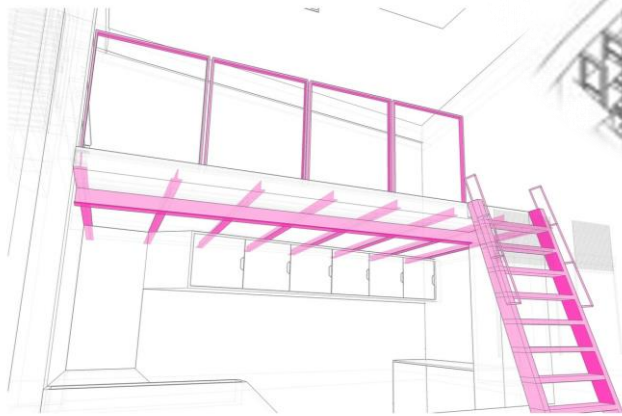

Mezzanine serves as a library cum break-out area with a custom designed metal bookshelf and pendant light.



### CAFETERIA



The bright yellow staircase at the end of the conference space leads you to a 1500 square foot cafeteria complete with a snack bar constructed in brick tiles

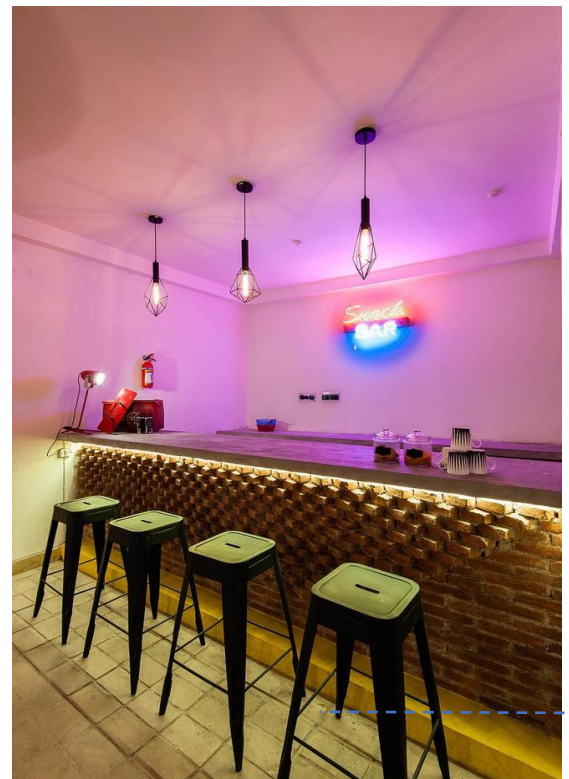



**INTERIOR VIEWS****SEMI CASUAL MEETING ROOM**

Besides the conference space, there is a semi-casual meeting area for 4 to 6 persons. The main wall in this room is enhanced with 4x3 grid letterboxes painted in white on a white wall for a subtle design experience. The USP of the workspace is in its ceiling-scape; inspired by a growing tree, it depicts the rapid growth of the dating app. The acrylic pendant lights, spots and tracks are all suspended from this royal blue structure.

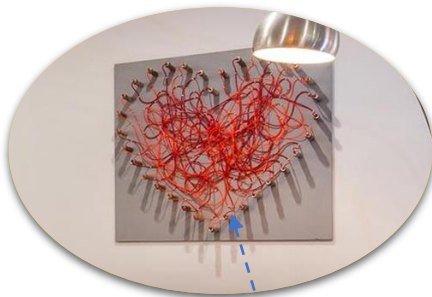
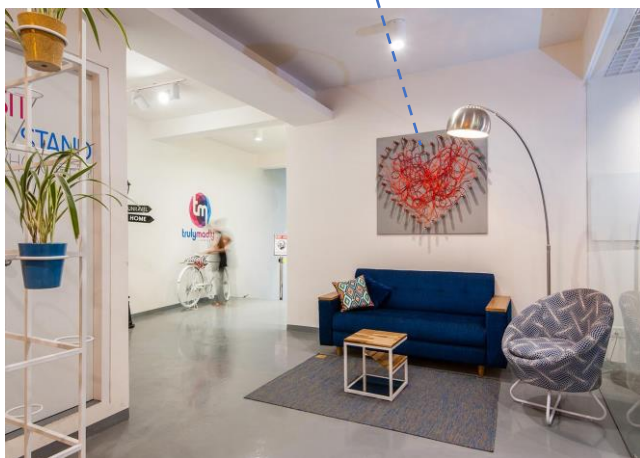
**WAITING AREA**

The simple heart-shaped nail string art in the waiting area also provides glimpse of what the office work goes like.

**LOBBY**

As one walks from the work area through the reception, a noisy corner is bound to grab your attention; our scrabble inspired wall is playful, interactive and keeps the guests occupied before and after meetings.



**INTERIOR VIEWS****CONFERENCE ROOM**

The conference and break-out space is highlighted by a floating box constructed in chipboard and glass which serves as the main board room with seating for 12-14 persons, we customized a 14 foot long modular-conference table finished in metal, chipboard and epoxy for the space.

**LEISURE SPACE**

This space serves as a rejuvenation spot or for mid-day breaks where one can relax in the grass or seat themselves on cane haystacks, which were customized to give a park-like feel and the bright yellow staircase leads to cafeteria.

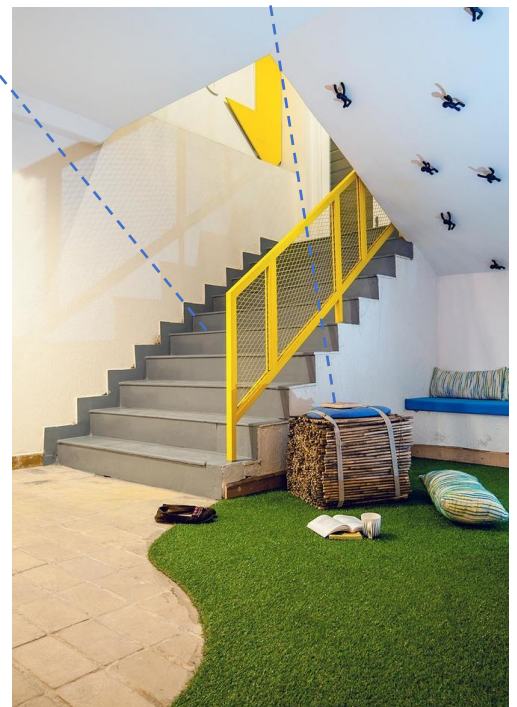

**02**

**CASE STUDY**



# COMMUNIQUE

## COMMUNIQUE MARKETING SOLUTIONS PVT LTD

From creative types, technology buffs, production wizards to number crunchers and logistic experts; we have an array of diverse talent on board. Virtual, on-ground, domestic, international, in-store and out of it; you name it and we do it. We love creating magic for brands wherever we get a chance.

**ARCHITECTS:** GROUPDCA

**AREA:** 7558 FT<sup>2</sup>

**YEAR:** 2018

**MANUFACTURERS:** ATLAS

SCHINDLER, KOHLER, SAINT-

GOBAIN, TRILUX, IGUZZINI, ASIAN

PAINTS, WEATHER COMFORT

**CITY:** DELHI

**COUNTRY:** INDIA

### ABOUT THE CITY

- Delhi shares borders with the state of Uttar Pradesh in the east and with the state of Haryana in the remaining directions.
- It covers an area of 1,484 sq. Km.
- It has an estimated population of over 28 million.
- It the largest metropolitan area in India and the second-largest in the world.

### SITE LOCATION

**Location:** 83, Phase Iv, Udyog Vihar, Sector 18, Gurugram, Haryana 122015

**Site Area:** 450 Sq. Mt.

**Site Shape:** Rectangular

**Latitude & Longitude:** 28°38'28"n 77°14'01"e



## CLIMATIC CONDITION

**Wind speed:** the average wind speed in Gurugram is 2.5 m/s with the maximum wind speed of around 8 m/s.

**Temperature:** the average ambient temperature remains 24.6 °c (76.3 °f).

**Rainfall:** the annual rainfall is 700 mm (27.6 inch).

## ACCESSIBILITY TO THE SITE

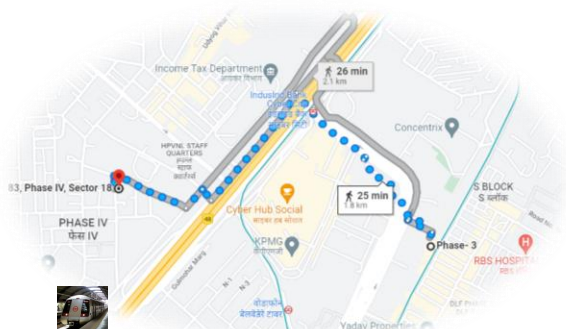

Phase III Metro Path 1.8km



I.G.I. Airport 15.9 Km



Palam Vihar Halt 6.6 Km

## LANDMARK



Sauch Tower



Carbon Adventure



Maxicus



Aihp Palms



## PLAN LAYOUT



1. Amphitheatre (Knowledge Centre)
2. Workstation Area
3. Men's Washroom
4. Women's Washroom
5. Balcony
6. Pantry
7. Informal Meeting Zone

**I FLOOR PLAN**



1. Conference Room
2. Double-height Space With Workstation Below
3. Men's Washroom
4. Women's Washroom
5. Balcony
6. Meeting Room

**II FLOOR PLAN**



1. Workstation
2. Balcony
3. Men's Washroom
4. Women's Washroom
5. Meeting Area Below

**II FLOOR UPPER LEVEL PLAN**



1. Wellness Centre And Yoga Studio
2. Terrace
3. Washroom

**III FLOOR PLAN**



## VIEWS



Front View



Isometric Night View

## SUN & WIND PATH DIAGRAM

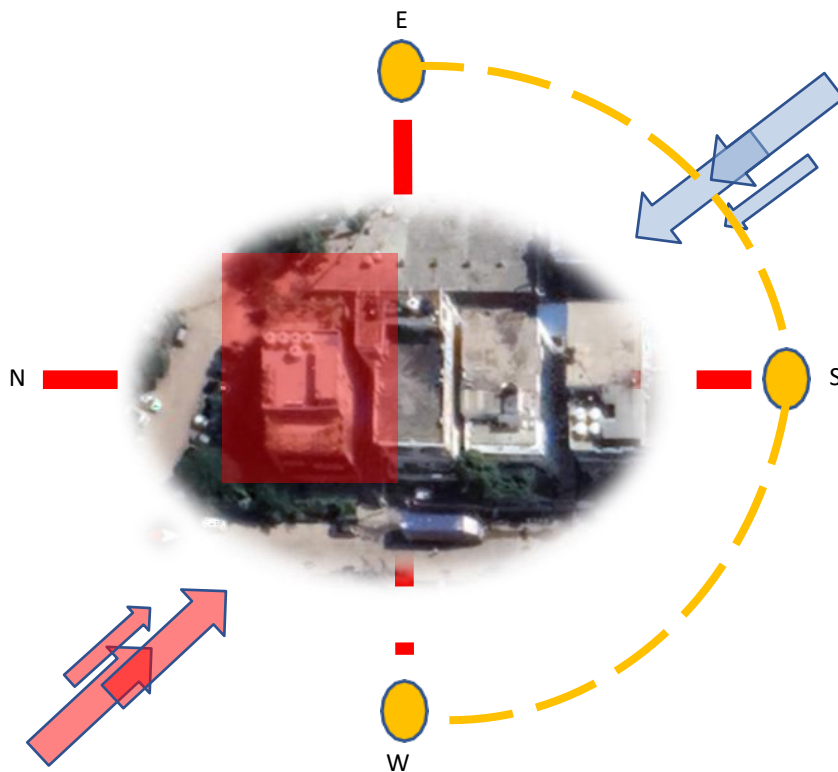

Isometric Morning View



Backside View

## CONCEPT

- The office, creates a **modern** and **egalitarian** workspace in an effort to foster **creativity, collaboration, and conversation**.
- Its spatial planning emerges as a direct result of this intent: where, an open-plan office.
- It provides a workspace that augments the well-being of its users in addition to their **professional productivity, by creating architecture** that celebrates **transparency, free thought, and collaboration**—architecture.
- The architectural vocabulary is unmistakably brutalist: the facades are an **expanse of exposed concrete** punctuated by the measured use of **Corten steel**.
- The third floor is conceived as a large unified space; the **wellness center** provides an uninterrupted space that can host a multitude of **communal events** such as **yoga and prayer meetings, and parties**.
- All of the windows are **double-glazed**, while **glass wool** is used as an insulating material on the **western façade**.

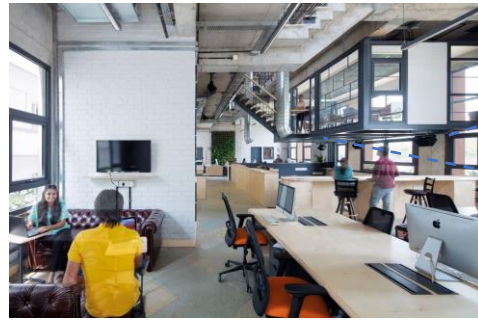

The highlight of the volume is a mezzanine conference room that floats above an amphitheater-style, multipurpose event area.

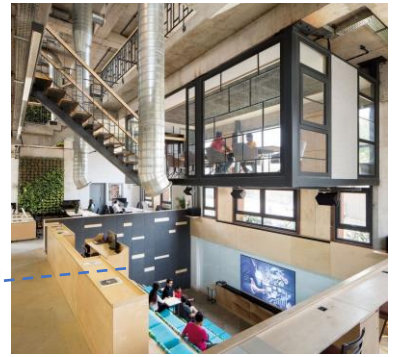

## MATERIALS

- The **wall and ceiling surfaces**—*concrete, brick, and Corten steel*—are **left exposed** in their natural, unfinished states.
- The **furniture** is carved out of *birch plywood*.
- The **flooring** is largely done in locally procured, *multi-hued limestone*.
- The **air-conditioning ducts** take on a sculptural quality; *left unconcealed*, they seem to *float in mid-air*, adding to the **raw and industrial** look of the space.
- These material choices help bring down *maintenance costs* significantly, while simultaneously enhancing user experience of the spaces.

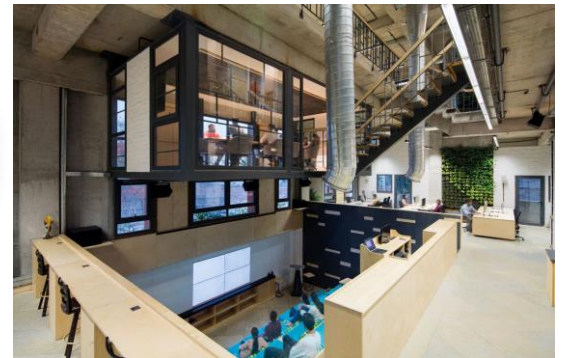

The upper floors house the workspaces within a seamless two-floor volume, accommodating a diverse function mix.



Exposed ceiling of the structure in workstation area. The larger design strategy—biophilia—endeavors to enhance human engagement with nature in order to craft working spaces that promote happiness, good health, and well-being. The attempt to optimize the building's thermal performance vertical green walls run along the entire two-floor length of the volume along its eastern and western edges.



Large windows are designed along the northern and southern edges, which ensures adequate daylight ingress. Due to its careful placement and sizing.





## INTRODUCTION

An office is a space where an organization's employees perform administrative work in order to support and realize objects and goals of the organization.



### Bubble Advertising Agency

BUBBLE is an advertising agency based in Prague, often referred to as a creative agency or an ad agency, is a business dedicated to creating, planning, and handling advertising and sometimes other forms of promotion and marketing for its clients.

## CONCEPT

The concept of the office design is based on the Japanese aesthetics

### “Wabi-Sabi”



*“Wabi-Sabi” (Perfect In Its Imperfections)?*

In traditional Japanese aesthetics, wabi-sabi is a world view centered on the acceptance of transience and imperfection. The aesthetic is sometimes described as one of appreciating beauty that is "**Imperfect (unfinished), Impermanent, and Incomplete**" in nature.

The *ideology* behind the concept is getting the work done perfectly but with its own imperfections. Hence justifying the statement, **“Wabi-Sabi” (Perfect In Its Imperfections).**

The fundamental principle of wabi-sabi interior design is connection to earth and natural materials, but with an accent to authenticity.

**Characteristics** of wabi-sabi aesthetics and principles include asymmetry, roughness, simplicity, economy, austerity, modesty, intimacy, and the appreciation of both natural objects and the forces of nature.

**WHY** This Concept?

As obvious, creative people need creative spaces to collaborate and to produce their best work that's why the space needs to be fun-loving, comfy and creative to get the best productivity of the workers (employees) while respecting and sustaining the man power. The 'unfinished' look in the design concept suggests that creative ideas are never finished.

## MATERIAL BOARD



## GYPSUM BOARD

FRAMED REQUIREMENTS

- |                |                      |                       |                            |
|----------------|----------------------|-----------------------|----------------------------|
| ▪ RECEPTION    | ▪ CHIEF EDITORS ROOM | ▪ ACCOUNTS DEPARTMENT | ▪ CONFERENCE ROOM          |
| ▪ WAITING AREA | ▪ EDITORS DESKS      | ▪ MANAGER'S ROOM      | ▪ MEETING ROOM             |
| ▪ WORKSTATIONS | ▪ CREATIVE DIRECTOR  | ▪ ASSISTANT MANAGER   | ▪ SEMI-CASUAL MEETING ROOM |
|                |                      | ▪ MEDIA SPECIALISTS   | ▪ CAFETERIA                |

BUBBLE DIAGRAM

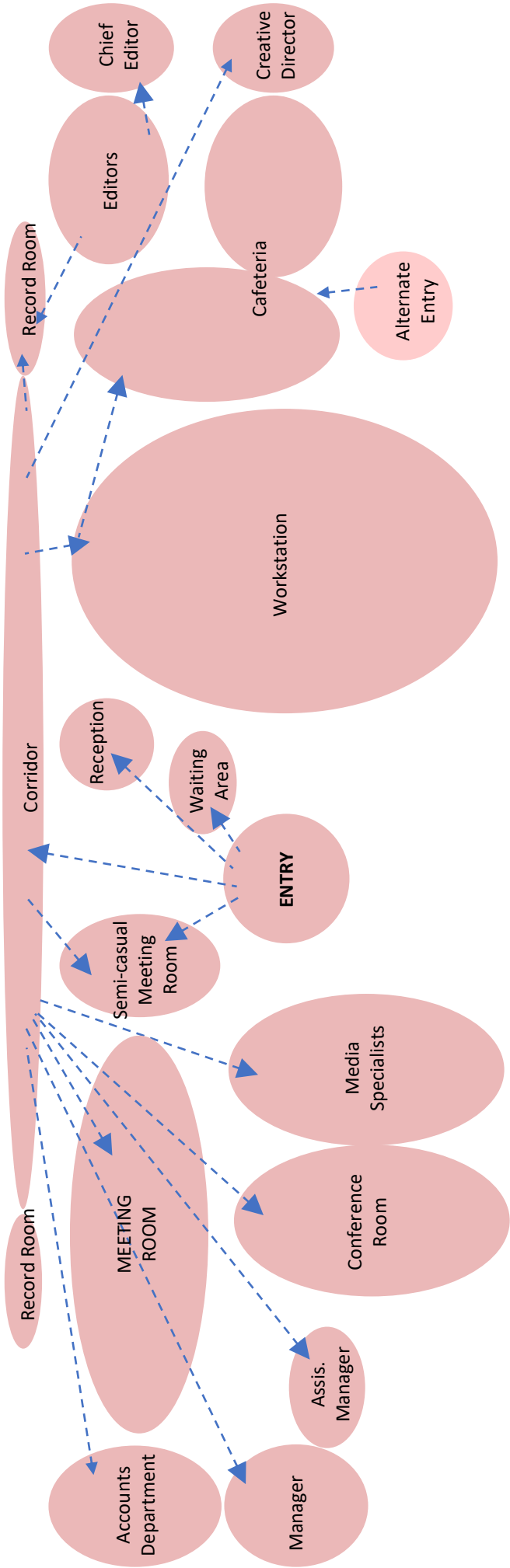



## ZONING

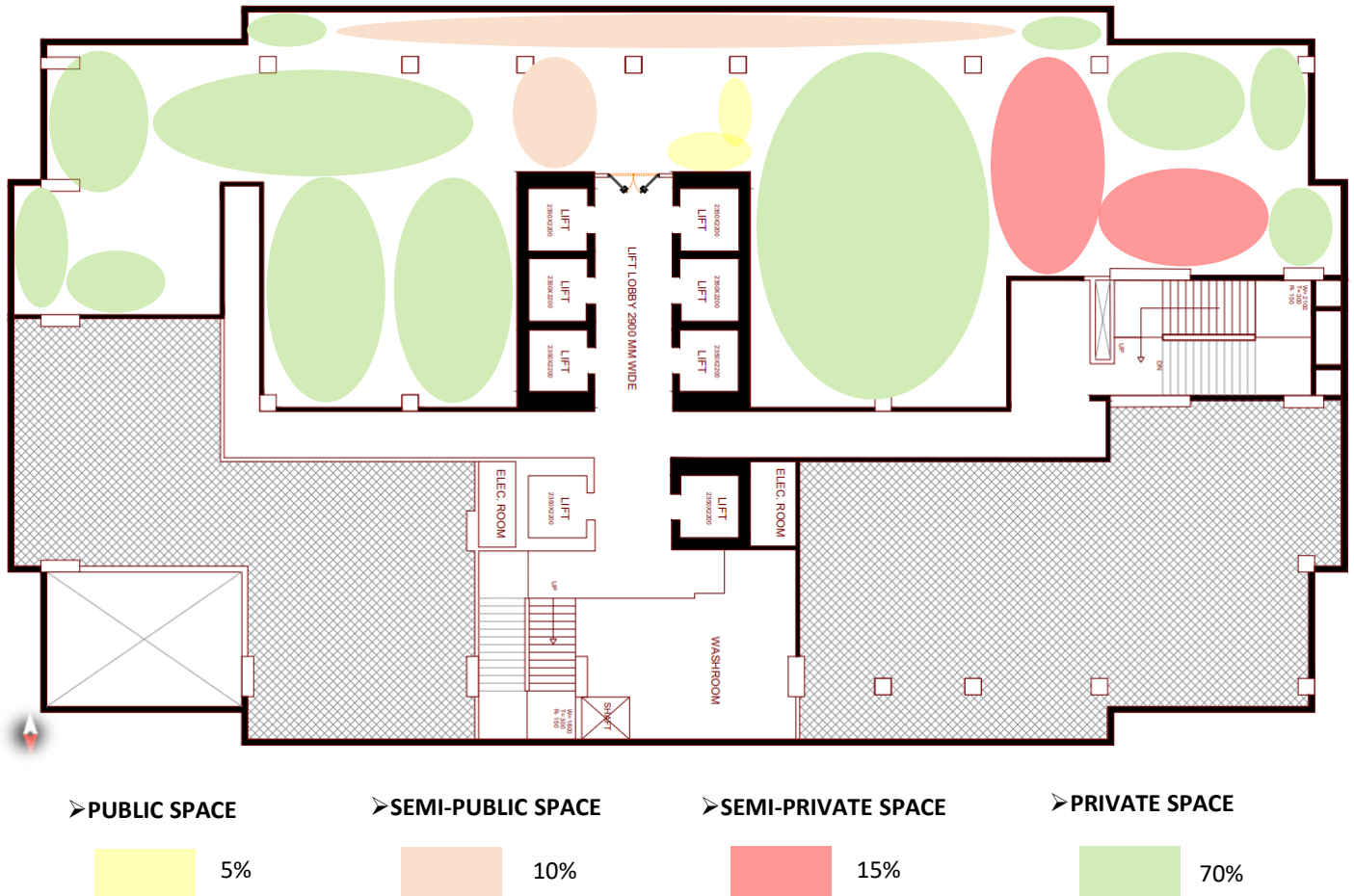

## INTERIORSCAPE



### AGLAONEMA PLANT

Helps to improve the air quality  
Filter indoor air pollutants and toxins  
Emits oxygen  
Increases productivity  
Requires moderate light and watering  
Enriching health and well-being in working spaces.



### ZZ PLANT (Zamioculcas)

### SNAKE PLANT

- Filter indoor air
- Remove toxic pollutants
- May help boost mental health
- Easy to care for
- Effective against allergies
- May help enhance the "energy" of a space
- Can help with minor ailments

### IMPORTANCE IN INTERIORS

- Aesthetic qualities.
- Enhances the sense of well being.
- Increases productivity.
- Replenishes focus.
- Improves air quality.
- Reduces stress.

- Removes pollutants
- Improves cognitive function
- Adaptive in nature
- Requires less watering
- Looks beautiful
- A Great Feng Shui Option
- It is an Amazing Tabletop plant

### BONSAI PLANT

Purifying Air  
Bonsai Will Lower Your Stress  
Good For General Well-being  
It Will Maintain Humidity  
Develops The Ability Of Patience  
Provides A Spark To Your Creativity  
Self Awareness Is What Your Develop  
Self Confidence Is A Benefit Of Bonsai

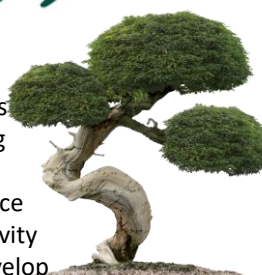

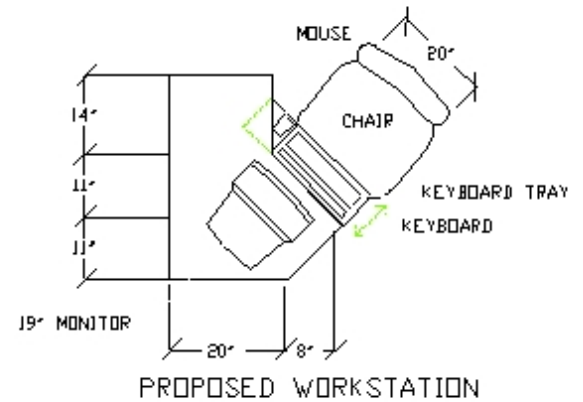
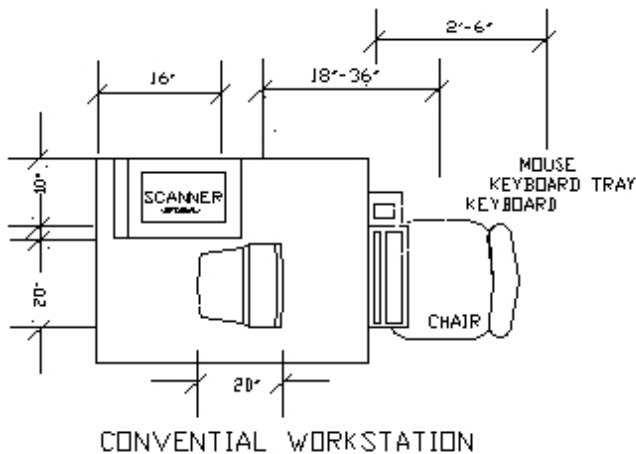
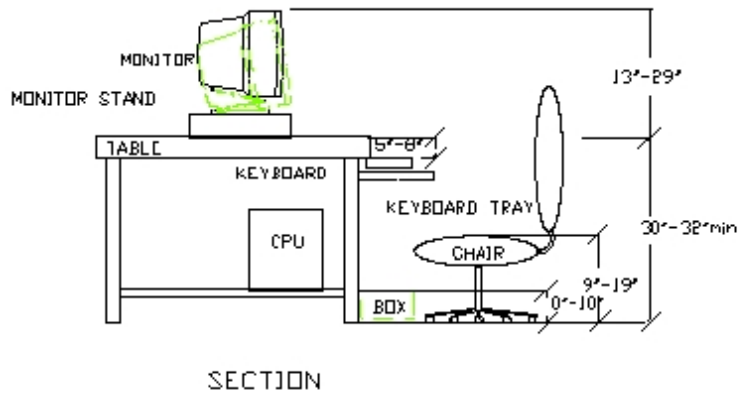
**ANTHROPOMETRY**

0.0ft. 2.0ft. 4.0ft.

TITLE WORKSTATION ADJUSTMENT		
DRAWN BY	DATE	SCALE
MM	11/28/00	1/4"=1'-0"

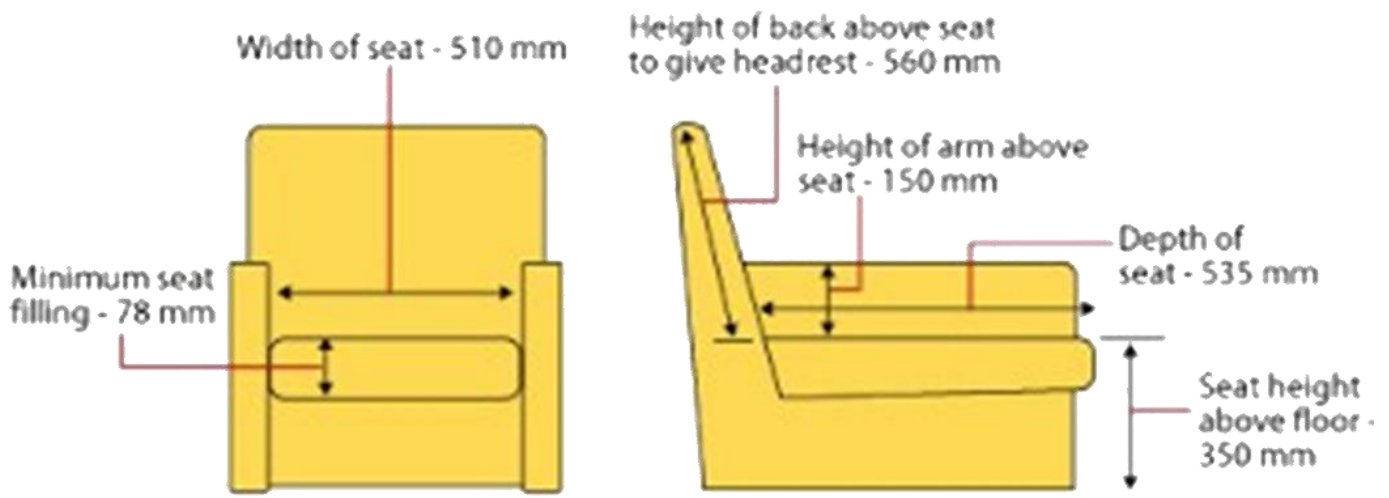
**WORKSTATION DESK****WAITING AREA SITTING**

# ANTHROPOMETRY

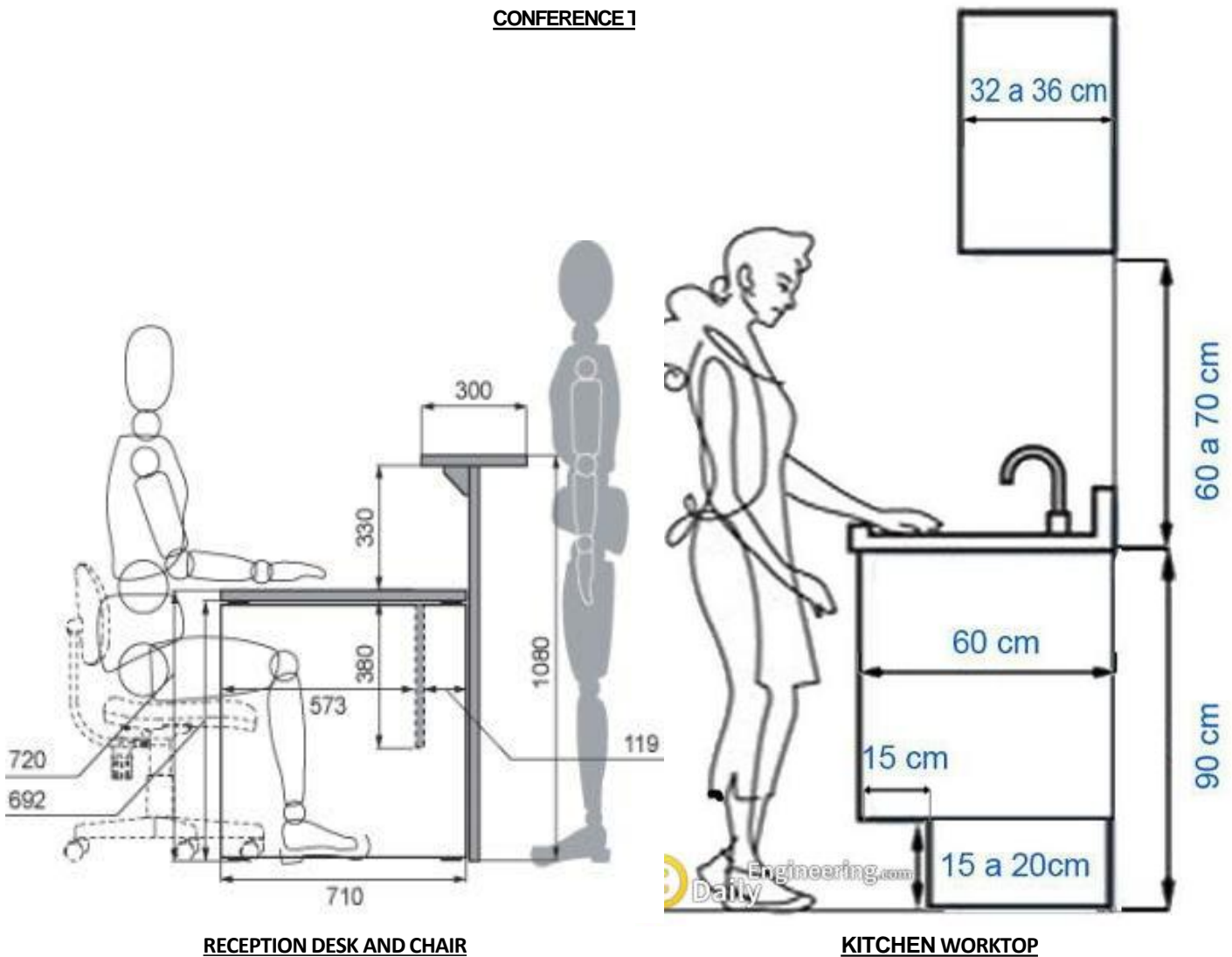
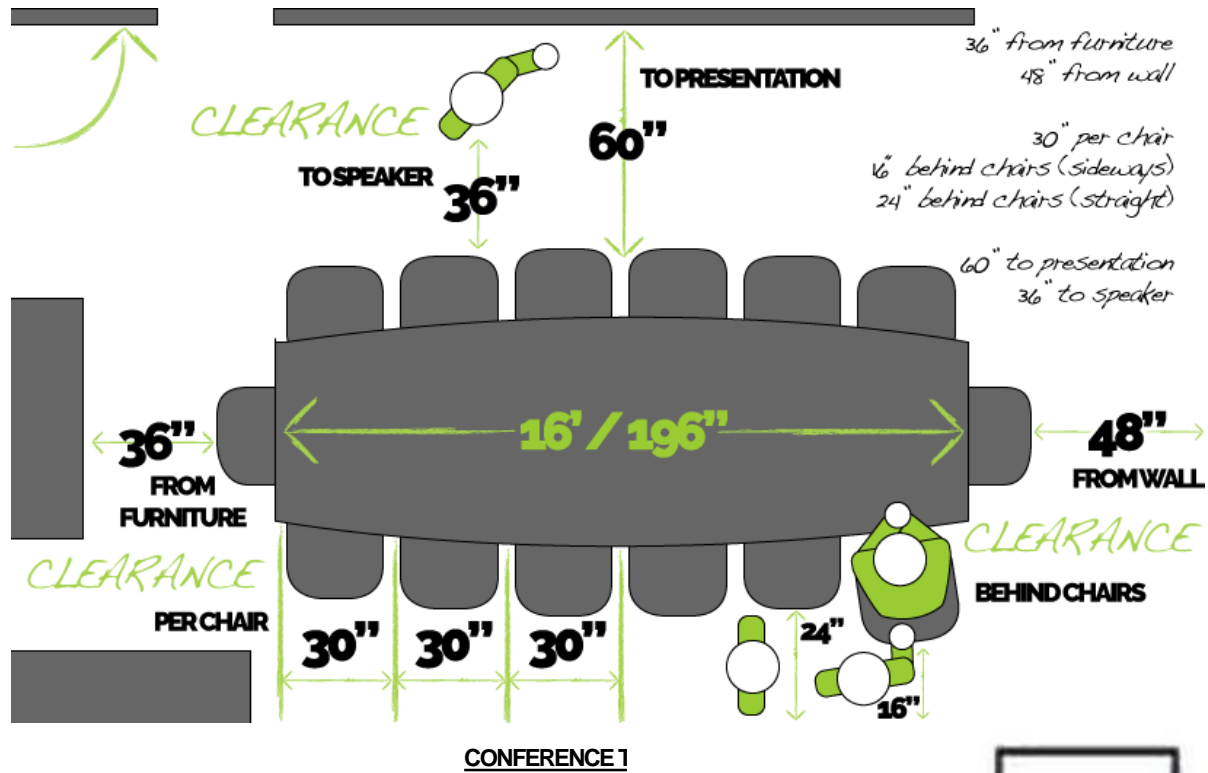



ANTHROPOMETRY

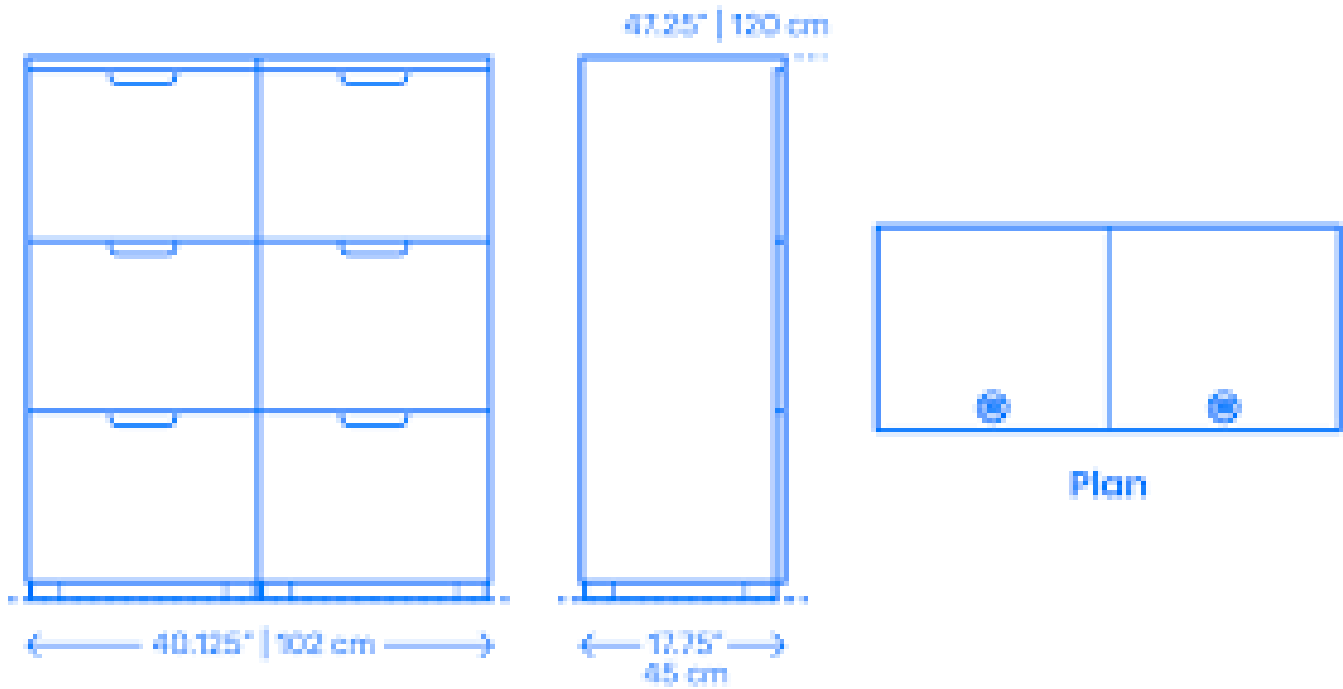

CABINETS

Dimensions.Guide | Stool Heights

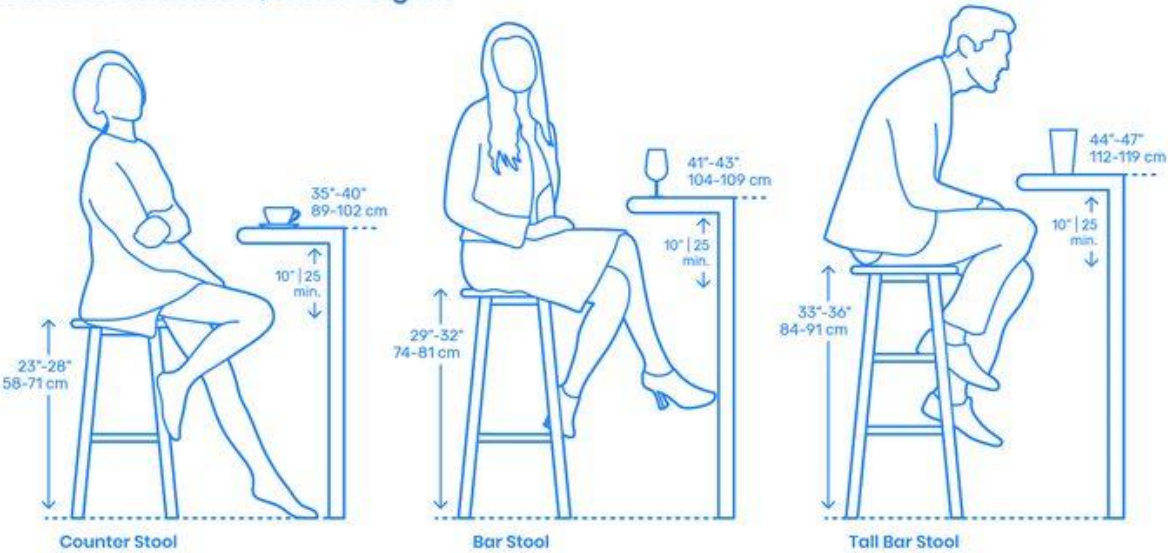

CAFETERIA STOOLS



PLAN

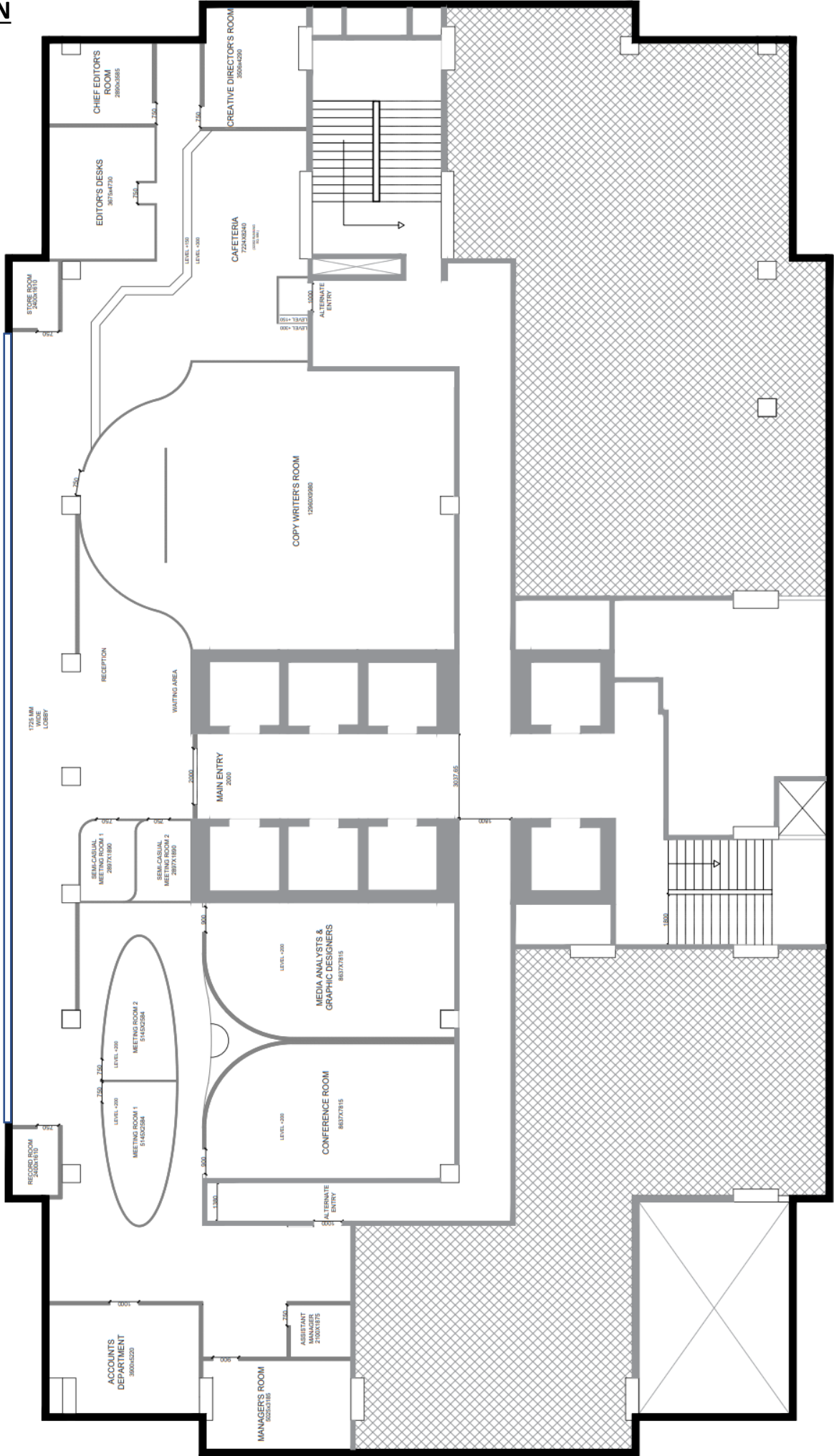

LAYOUT PLAN



## FURNITURE LAYOUT PLAN

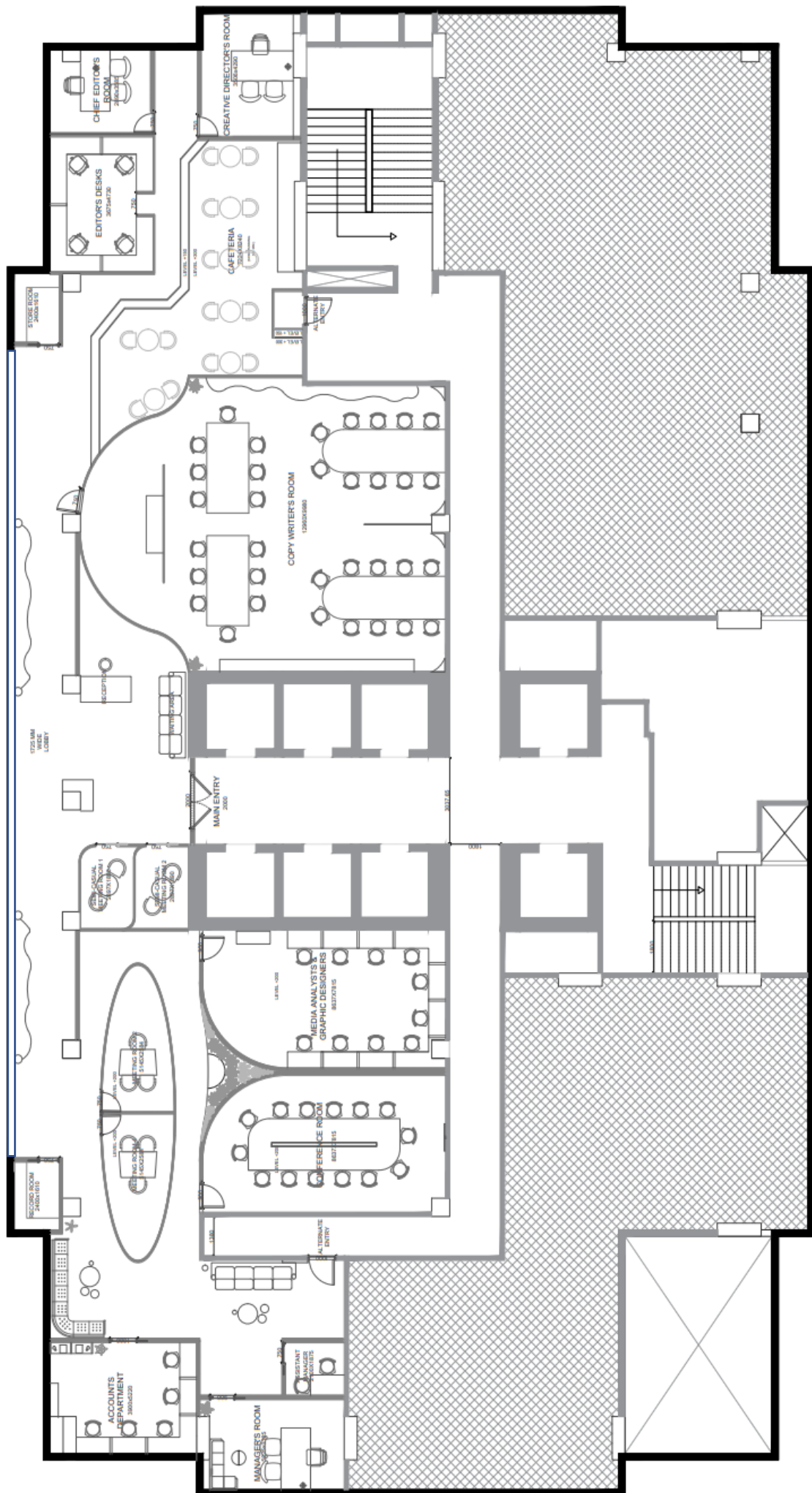

**MEDIA ANALYSTS &  
CONFERENCE ROOM  
ELEVATIONS**



MEDIA ANALYSTS AND CONFERENCE ROOM ELEVATION 'A'

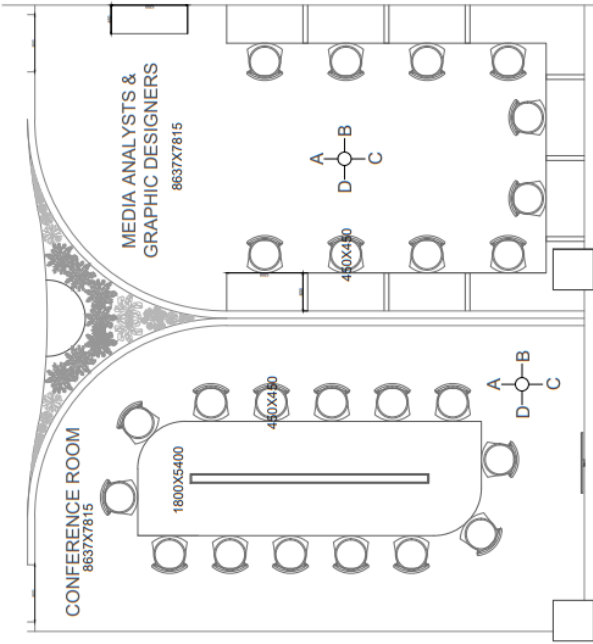

CONFERENCE ROOM ELEVATION 'B'

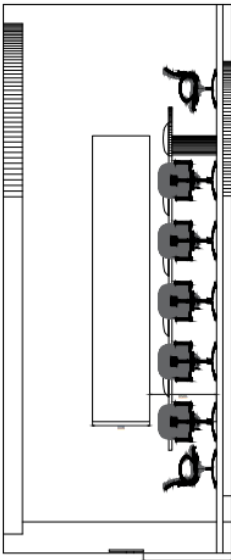
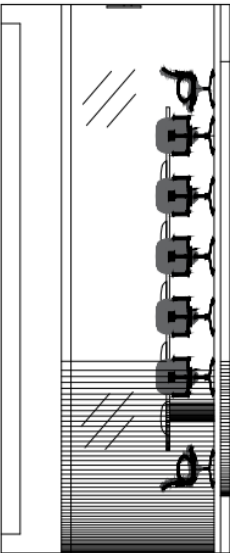

CONFERENCE ROOM ELEVATION 'D'

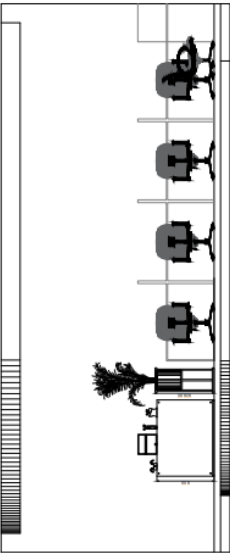

MEDIA ANALYSTS ELEVATION 'B'

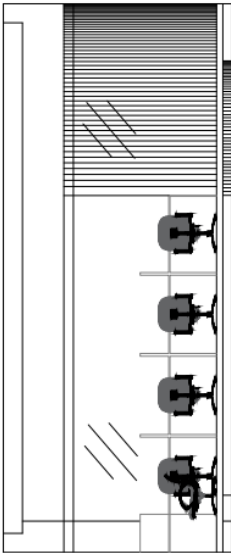

MEDIA ANALYSTS ELEVATION 'D'

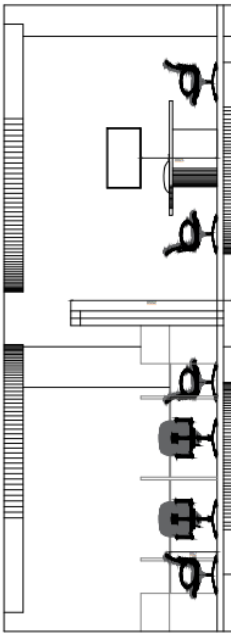

MEDIA ANALYSTS AND CONFERENCE ROOM ELEVATION 'C'



LAYOUT PLAN

**WORKSTATION/CONTENT CREATOR'S  
ROOM ELEVATIONS**

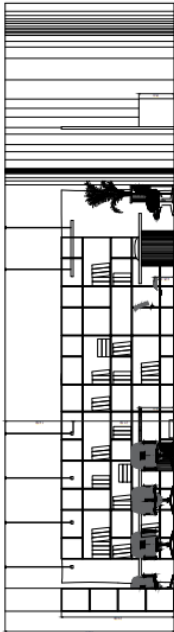
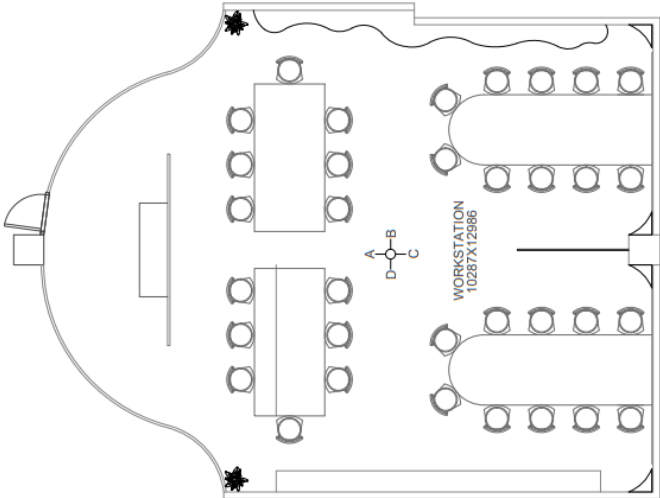
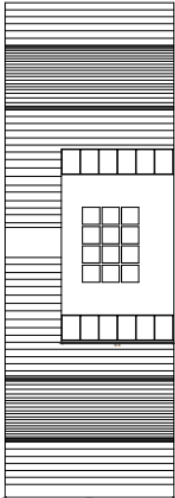

WORKSTATION ELEVATION 'B'

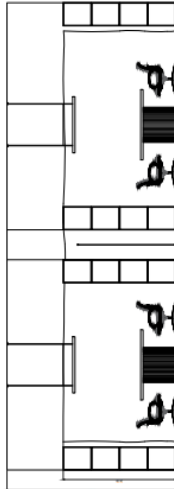
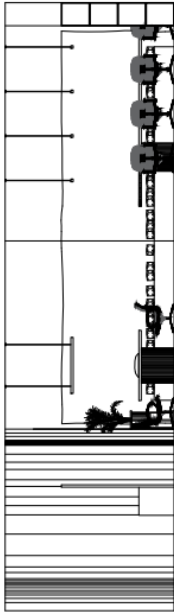



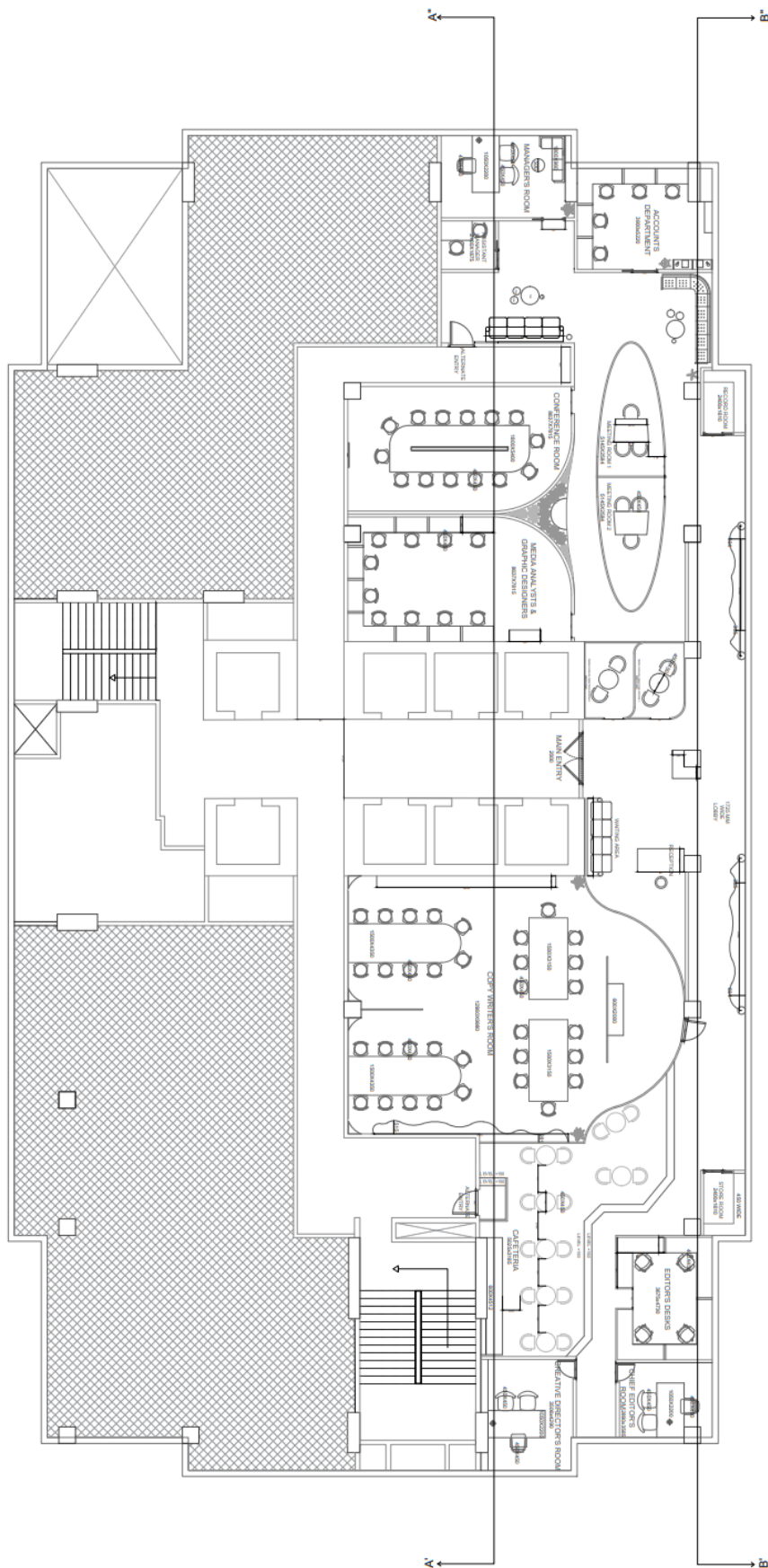

FLOORING



Materials Used In FLOORING

- Beige Rough Texture CC Flooring (size 600x600 MM) (40 MM thickness) 25 RS per sq. Ft.
- Grey Rough Texture CC Flooring (size 600x600 MM) (40 MM thickness) 25 RS per sq. Ft.
- Dark Shade Wooden Flooring (size 250X1200 MM) (10 MM thickness)
- Light Shade Wooden Flooring (size 250X1200 MM) (10 MM thickness)

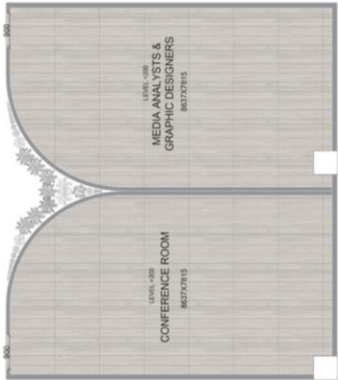

Conference Room, Media Analyst Room And Meeting Rooms Are Levelled Up With 200 Mm

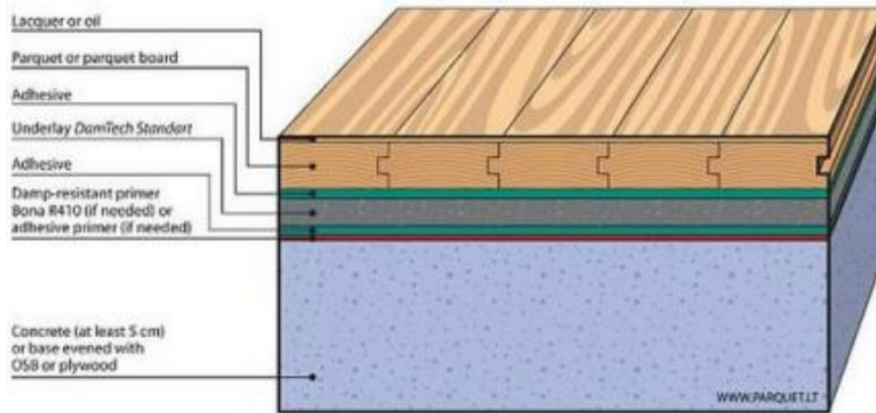
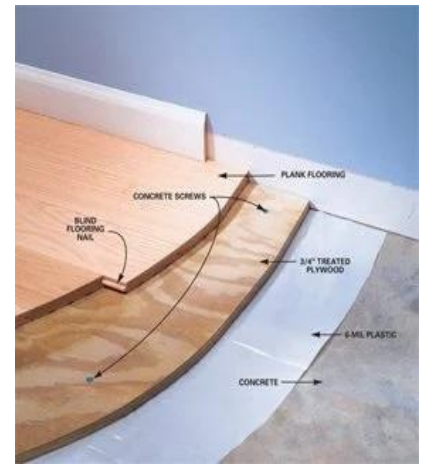
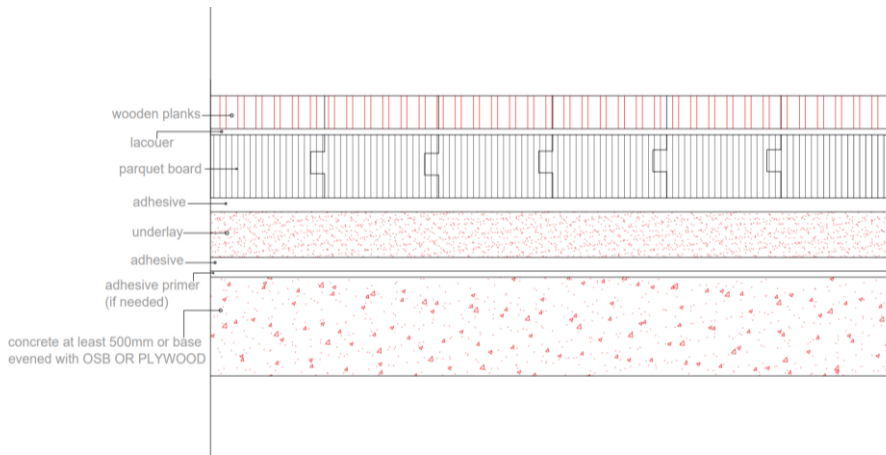
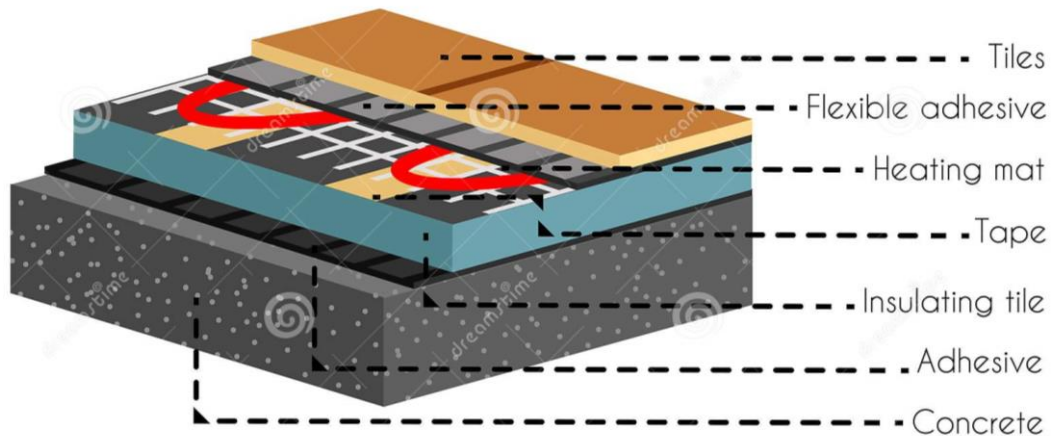
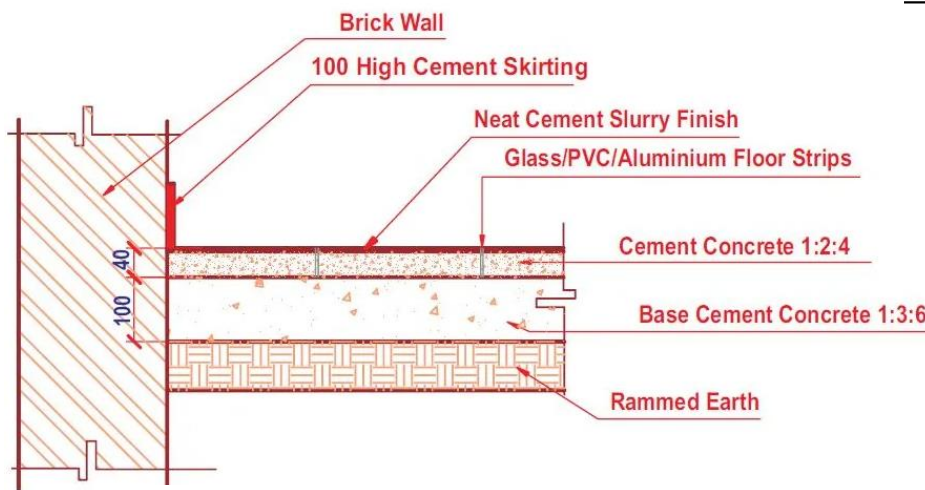

**WOODEN FLOORING****CEMENT CONCRETE FLOORING**



## REFLECTED CEILING PLAN

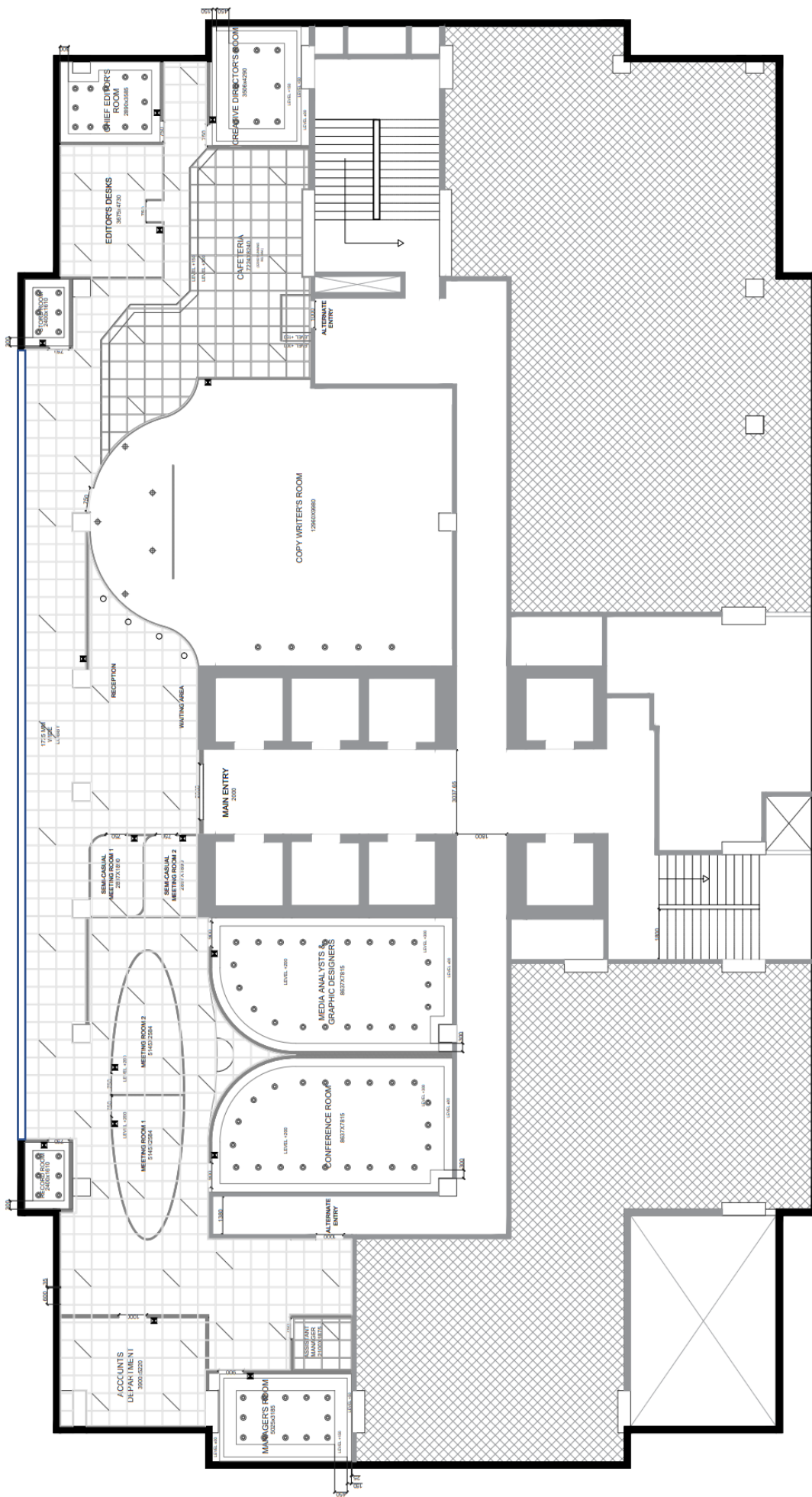

## Materials Used In Ceiling

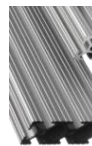

Aluminum IS USED FOR MAKING CHANNELS/FRAMES FOR GRID CEILING



Gypsum board (Size 600x600 MM, Thickness 12 MM) is used in Grid Ceiling and Gypsum board with (12 MM Thickness) is used in false ceiling

## GRID CEILING

Installation of round slot iron type (Side View)

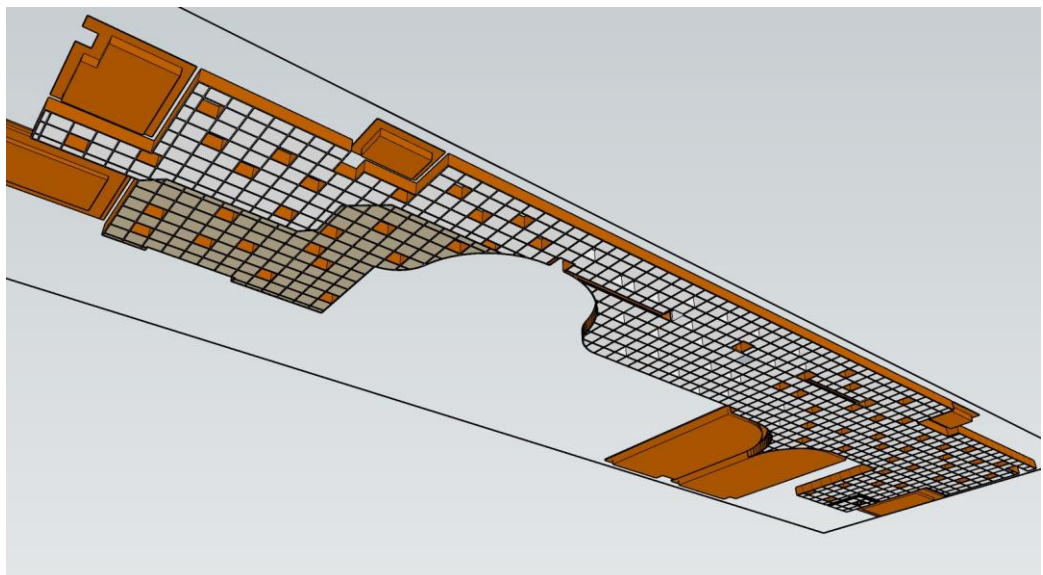
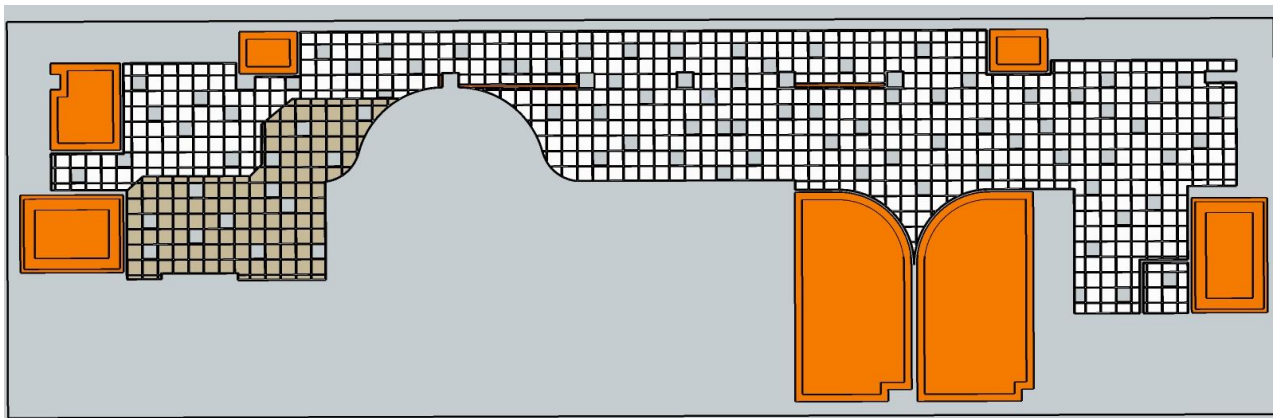
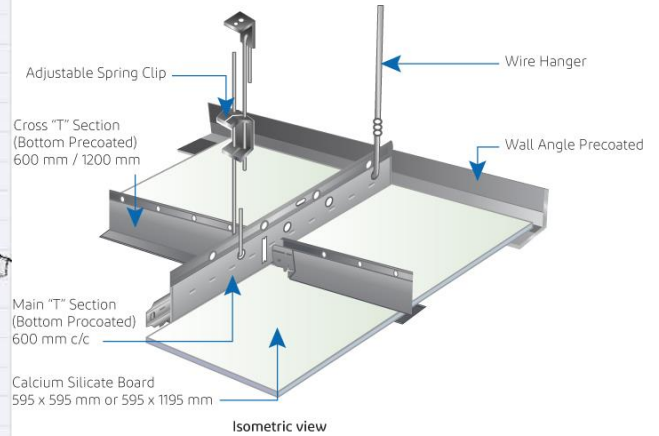
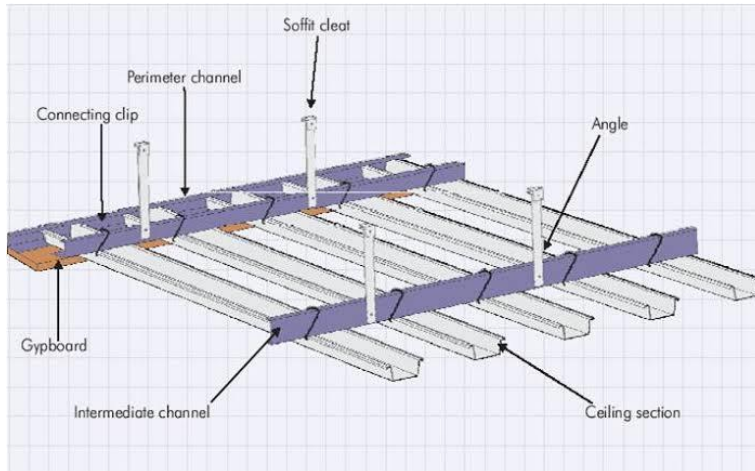
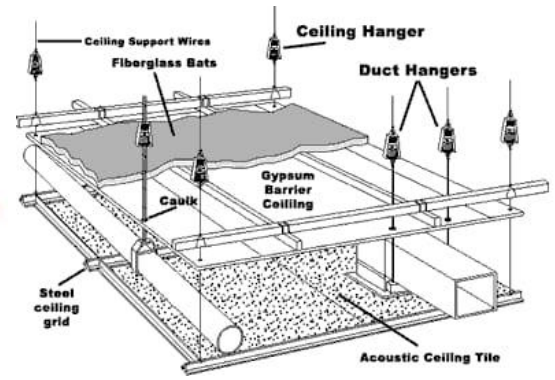
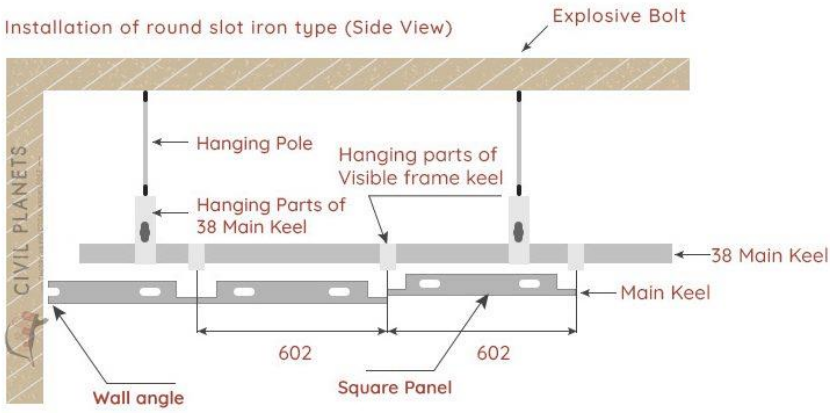



## LIGHTING

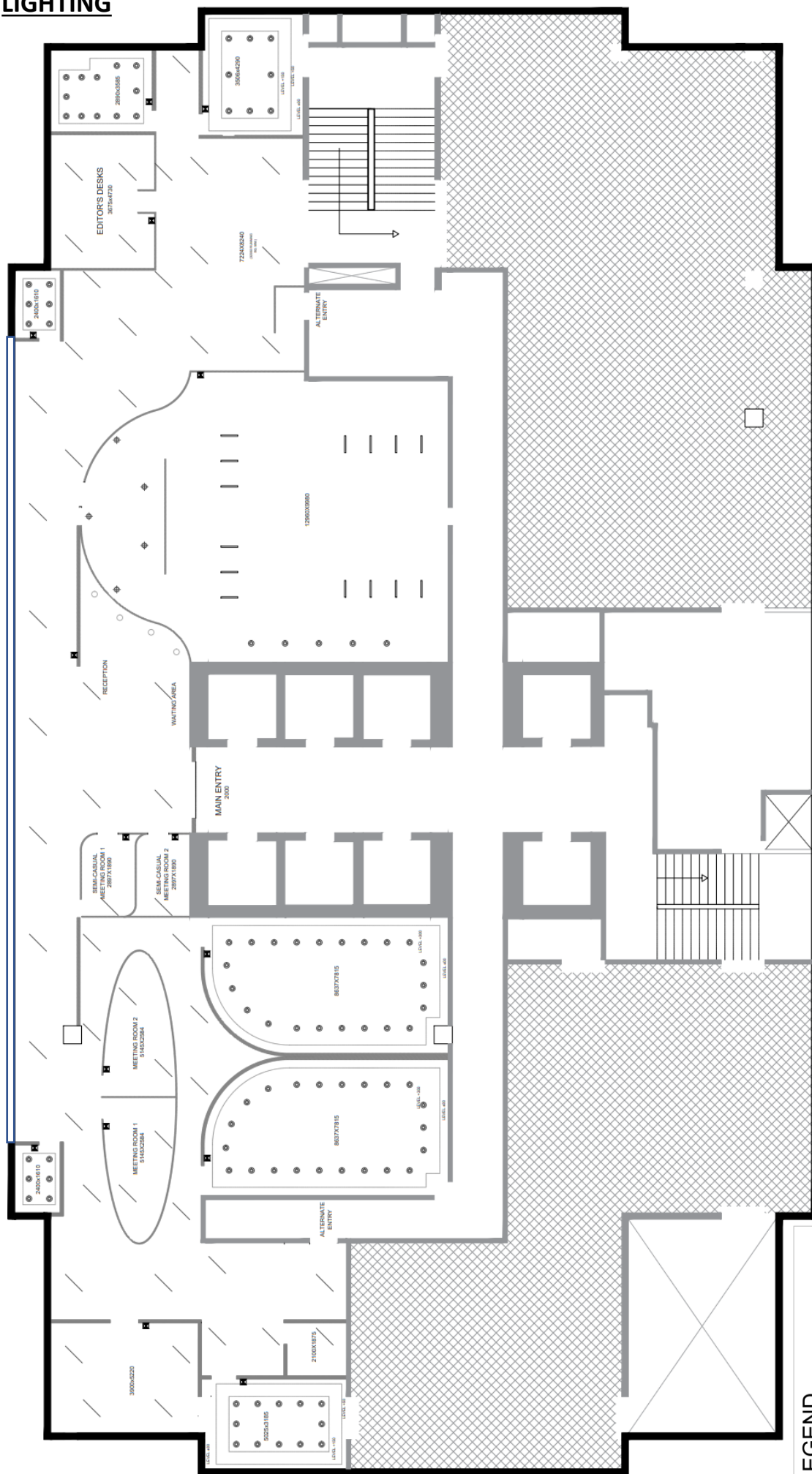

## LIGHTING FIXTURE

	LEGEND
	COB LIGHT
	PENDANT LIGHT
	DOWNLIGHTER
	HANGING LIGHT
	POWER BOARD



**LIGHTING FIXTURE****BACKLIT PANNEL****HANGING LED TUBELIGHT****PENDANT TUBELIGHT****COB LIGHT**

## LIGHTING

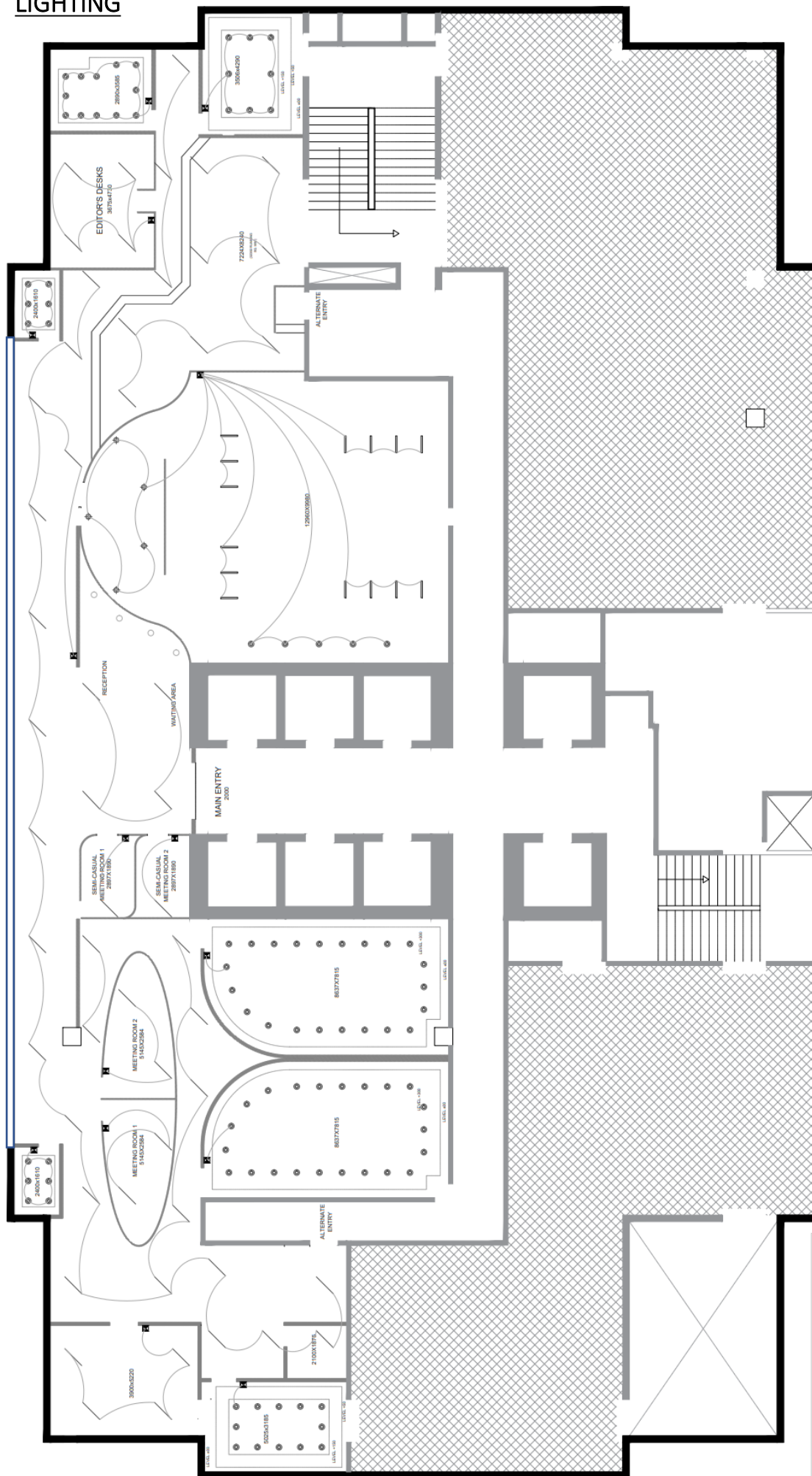

## LEGEND

	COB LIGHT
	PENDANT LIGHT
	DOWNLIGHTER
	HANGING LIGHT
	POWER BOARD

## LOOPING LAYOUT

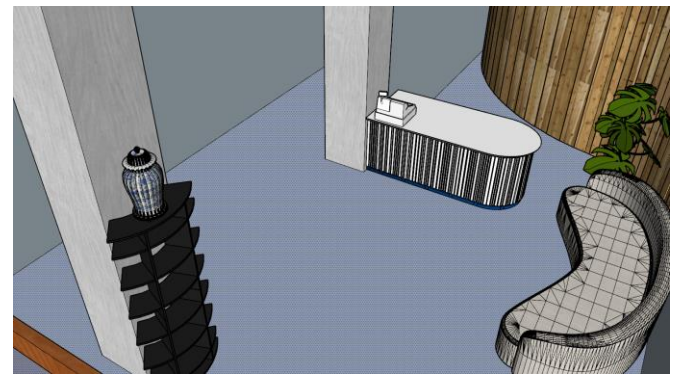
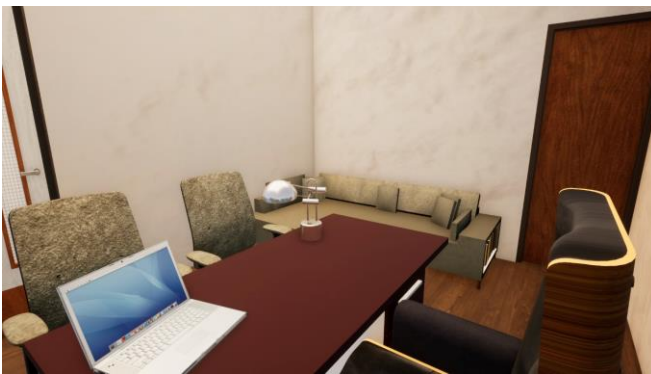
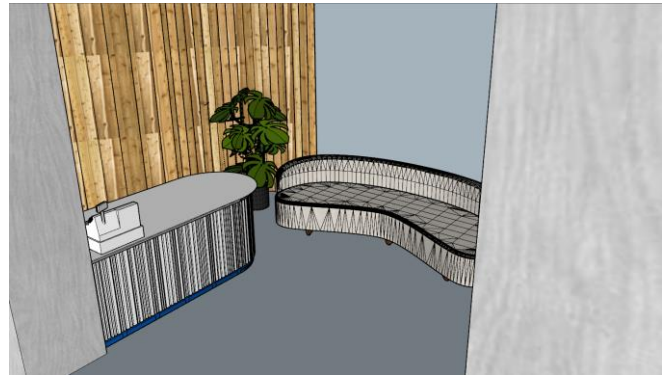

3D VIEWSFURNITURE

Cafeteria Table Is 750 Mm Round Table  
With Subtle 450x450 MM Chair



Workstation Table Is 1500x4350 Mm With 750 MM Height  
Cit Also Comprises Of 450x450 MM Ergonomics Chair.